

Hanex[®] Solid Surfaces
by Hanuha Surfaces

COLORS



ENGINEERED TO INSPIRE

Created to inspire and positively affect the places people work, live, play and shop. That's what designers do, and we want to help. Let our solid surfaces unleash your imagination, down to the tiniest detail, they've been engineered to do just that — inspire.

How? It's simple. They're durable and versatile with limitless design possibilities. Nonporous and stain-resistant. Look over our colors and contact us. We'd love to hear from you, and who knows, maybe we will inspire you, too.



Hanwha Surfaces is committed to delivering products made to perfection. For more information, please refer to the Technical Specifications section at www.hanwhasurfaces.com



BELLASSIMO EPISODE II

The colors within our Bellissimo Ep II Collection fuse versatility with beauty. Shades and patterns are inspired from conversations with designers and architects all around the country. Each engineered to help you create an environment that impacts everyday lives.

The designs themselves are inspired by the flow of nature: ocean waves, winds rustling trees, shifting sands and craggy stone. Making them a perfect fit for a range of stylistic choices, from modernism to something timeless.



 RANDOM VEINING



BELLASSIMO

Inspired by the gorgeous patterns and distinctive colors found only in nature, this unique and irresistible collection fuses sophistication with luxury, and unparalleled design with rapturous natural appeal.

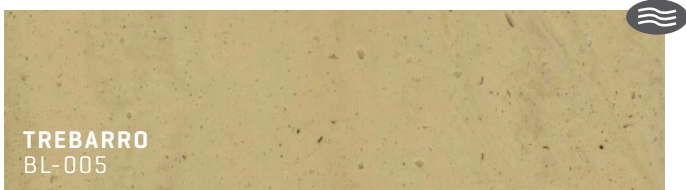
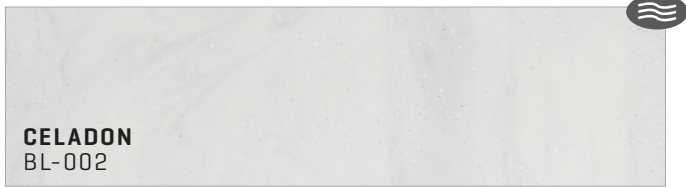
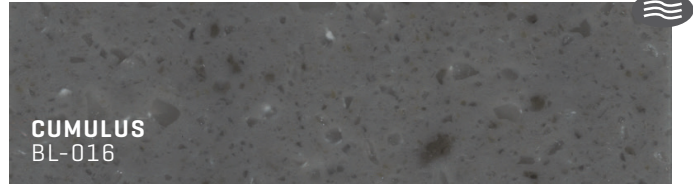



CLASSICS

Crafted from a unique blend of acrylic resins and natural materials, our Classics Collection offers endless design possibilities with a wide variety of color combinations, textures and hues – inspired by the wonder of nature.

SOLO

NEO WHITE
HL-003

WHITE
HL-001

IVORY
HL-002

AQUEOUS
S-014

HYDRA
S-013

METAL GREY
P-002

BEIGE BREEZE
S-018

BROWN FEVER
S-019

DUO

SILVERSTONE
HL-021

RICECOOKIE
T-068

LIGHT BROWN
HL-031

MIST
HL-027

GOLD BROWN
HL-023

DIJON BEIGE
HL-507

SANDBANK
HL-028

NAVAJO
HL-505

AMBER
HL-038

GINGER BREAD
RE-004

Colors are representative and will vary slightly from the actual product.



MIST
H-IVORY
HAVANA SAND

MINIMUM 2% RECYCLED CONTENT
PRE-CONSUMER



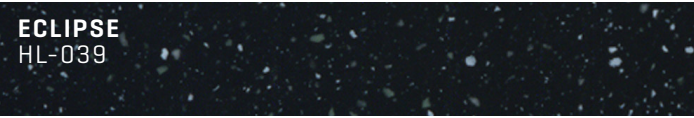
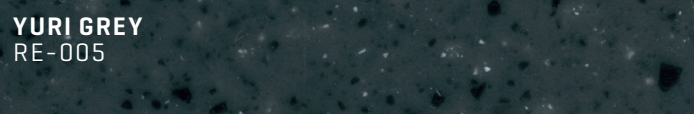
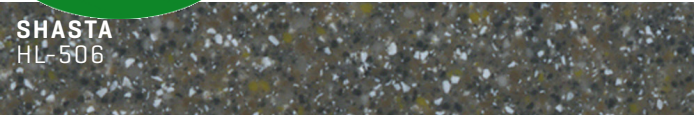

PALAZZO

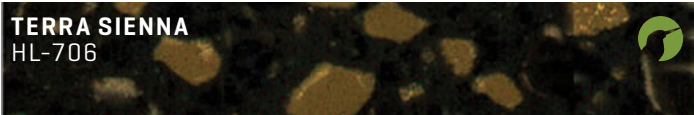
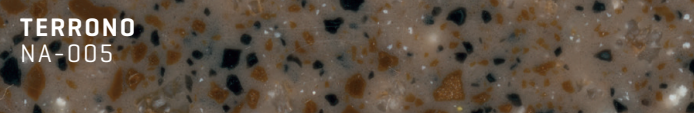
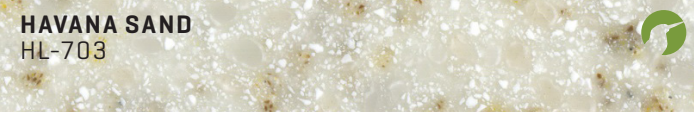

TRIO

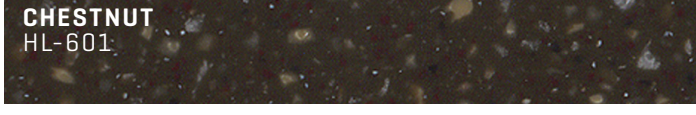
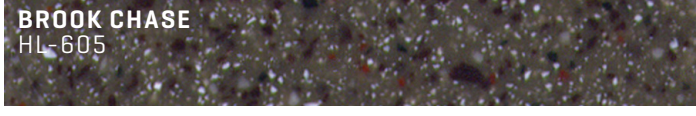
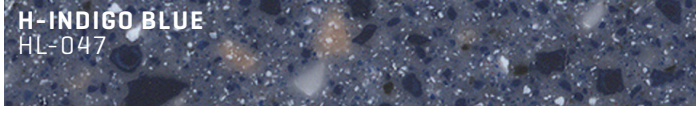
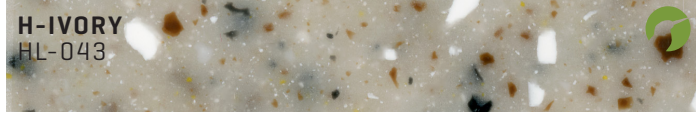
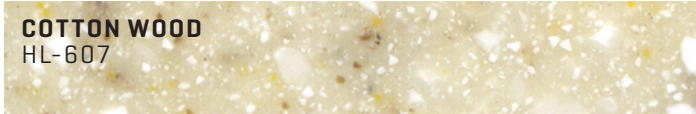
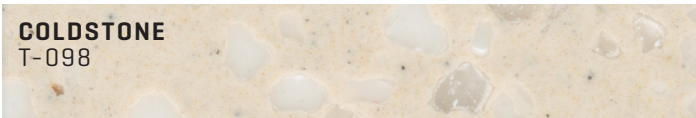

Colors are representative and will vary slightly from the actual product.



TERRA SIENNA



MINIMUM 10% RECYCLED CONTENT
PRE-CONSUMER



BRIONNE

Crisp, clean and pure are the very essence of this collection. Featuring a soft, luminous sheen, spread across a rich spectrum of colors and patterns. Regardless of the particular pairing of shape and hue that you select, the result has been engineered to 'wow.'

HELSINKI
B-031

OSLO WHITE
B-012

MERINO GREY
B-036

FLORIDA BEACH
B-032

IVORY ESSENCE
B-001

BOŠQUE
B-013

RHYTHMIC SHINE
B-019

PIEDMONT
B-021

JEWEL BEACH
B-037

TRIBELLA
B-009

WILD SAFARI
B-038

EPILOGUE
B-005

TUMORO
B-025

COPPER BLACK
B-040

WILD FIRE
B-039

1/4" AVAILABLE

1/4" Only for vertical surfaces.

NEO WHITE
HL-103

IVORY
HL-102

GOLD BROWN
HL-123

1613-VO Universal Design Lavatory Bowl

1613-VO

I.D.: 16 3/8" x 13"

Depth: 5"*

*Depth does not include counter top thickness



The newly updated **Gemstone** 1613-VO universal design lavatory bowl is the most popular sink style in the industry. With it's 5" depth, the bowl fits well in all applications, especially ADA applications as well as residential, commercial, healthcare, hospitality, and more. The 1613 has a smooth integral (non-corrugated) overflow which minimizes trapped bacteria in the overflow tube itself. The design is sleek & efficient with unparalleled ease of installation & performance. **Gemstone Sinks** are compatible and warranted when used with all major solid surface sheet brands (acrylic & polyester) with the same sheet warranties.

Gemstone supports conservation and green building practices and may contribute toward achieving LEED® building certification in commercial projects. All Gemstone Sinks use resin containing 15% post-consumer recycled content and 5.5% rapidly renewable materials.

Gemstone sinks are proudly made in the USA.

Gemstone sinks are certified by:

Home Innovation Lab (NAHB) (ANSI Z124.3)

UL in the US and Canada (ANSI Z124.3 & B45.0-99)

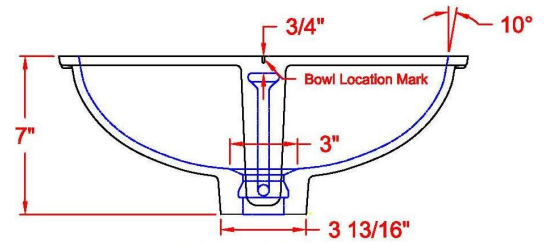
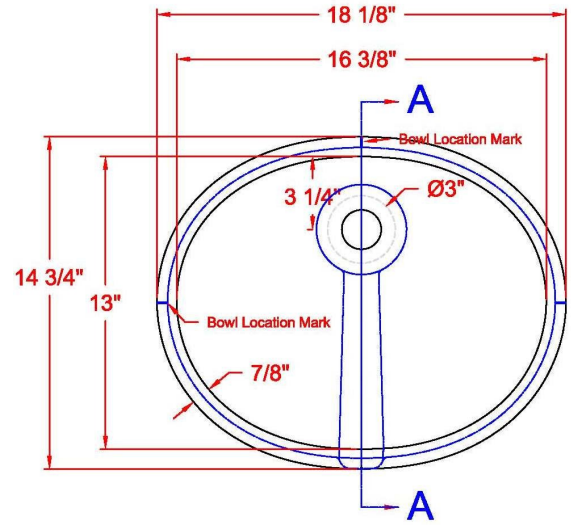

Front View

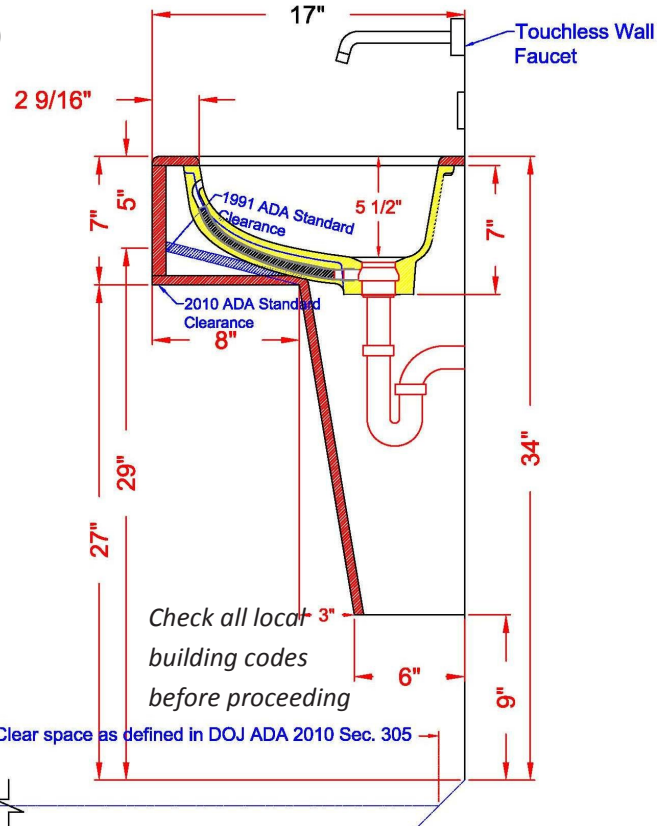

48" Clear space as defined in DOJ ADA 2010 Sec. 305

Introducing the industry's first universally designed oval solid surface lavatory bowl. Over the course of time, it becomes necessary to update tooling and models to meet the needs of designers, fabricators and users. For this reason, Gemstone is taking the opportunity to improve its most popular sink model and bring it up-to-date with Universal Design in mind.



Updated Gemstone 1613-VO Universal Design

While the former model will continue to offer lasting good looks and performance, the subtle changes to this updated model will simplify ADA location and fabrication issues of the past. The 5" ID (only 5/16" difference from the former model, & 1/2" different from other popular models) will allow the vanity bowl to be installed in smaller vanity tops and still easily conform to ADA standards and even allow for easy bottom-of-the-bowl cover-up! Say goodbye to headaches of the past and hello to installation ease. In addition, consistency with draft angles (10°) will allow for faster fabrication and sanding. The sink is a little lighter for easier shipping and handling, yet the overall look will remain almost identical from a users standpoint to the existing model. This sink was truly designed with architects, designers, fabricators and users in mind!

Other Features include:

- Narrower flange is easier to locate, glue and mount
- Narrow overflow chamber is sleeker & lighter
- Smooth overflow tube is preferred in hospitals

Available October 1, 2014

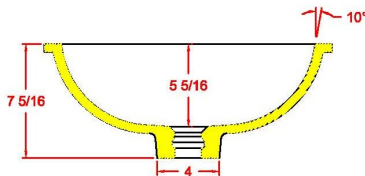
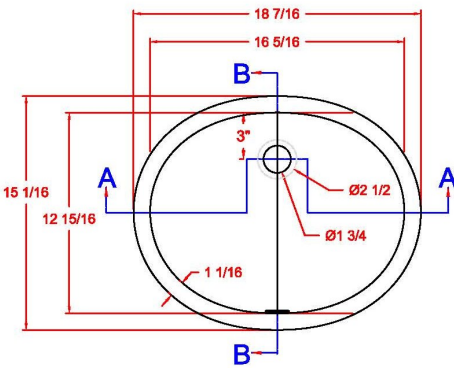

Section A-A

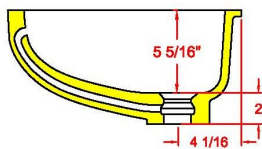

Section B-B
Retiring 1613-VO

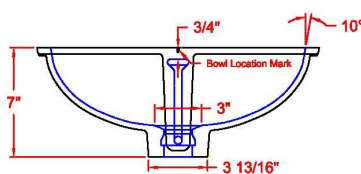
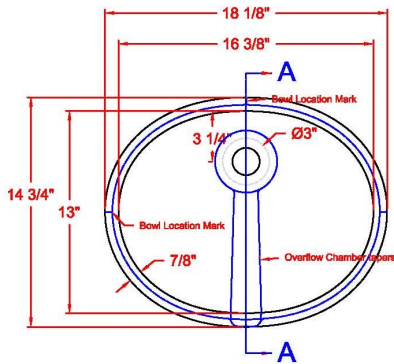

Front View

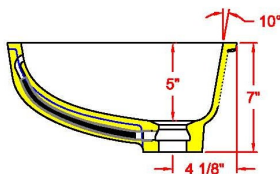

Section A-A

Updated 1613-VO Universal Design

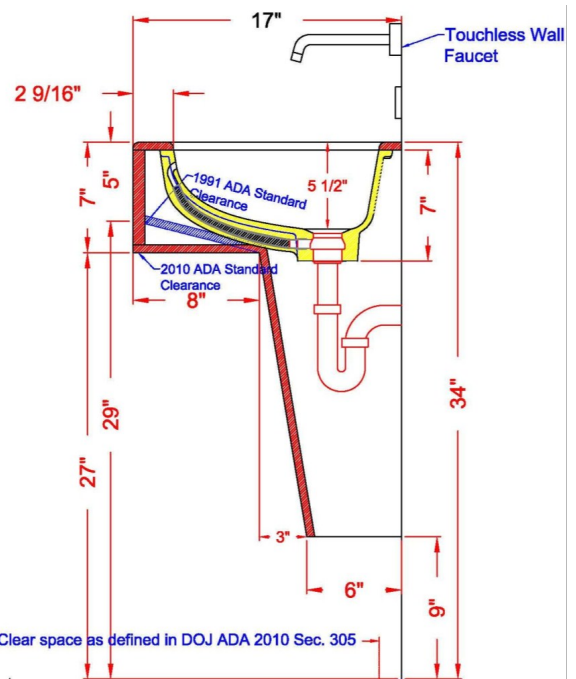

1711-UVO Lavatory Bowl

1711-UVO

I.D.: 17 3/4" x 10 13/16"

Depth: 5"*

*Depth does not include counter top thickness

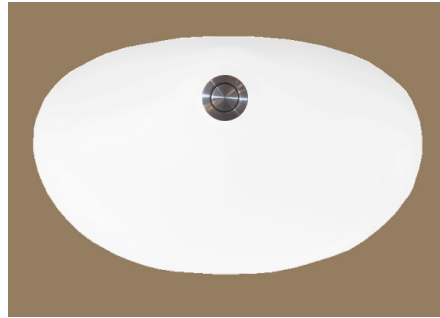

The **Gemstone** 1711-UVO lavatory bowl, with integrated overflow, has the correct dimensioning to fit comfortably in a shallow 18" cabinet and the right depth to make it a universal design sink giving it the flexibility to install in any application. The size of 1711-UVO also allows it to look exceptional in standard depth cabinets as well. The shape of the bowl is not your typical oval and adds class and elegance to the vanity top while yielding uncompromising performance.

Gemstone Sinks are compatible and warranted when used with all major solid surface sheet brands (acrylic and polyester) with the same sheet warranties.

Gemstone supports conservation and green building practices and may contribute toward achieving LEED® building certification in commercial projects. All Gemstone Sinks use resin containing 15% post-consumer recycled content and 5.5% rapidly renewable materials.

Gemstone sinks are proudly made in the USA.

Gemstone sinks are certified by:

Home Innovation Lab (NAHB) (ANSI Z124.3)
UL in the US and Canada (ANSI Z124.3 & B45.0-99)

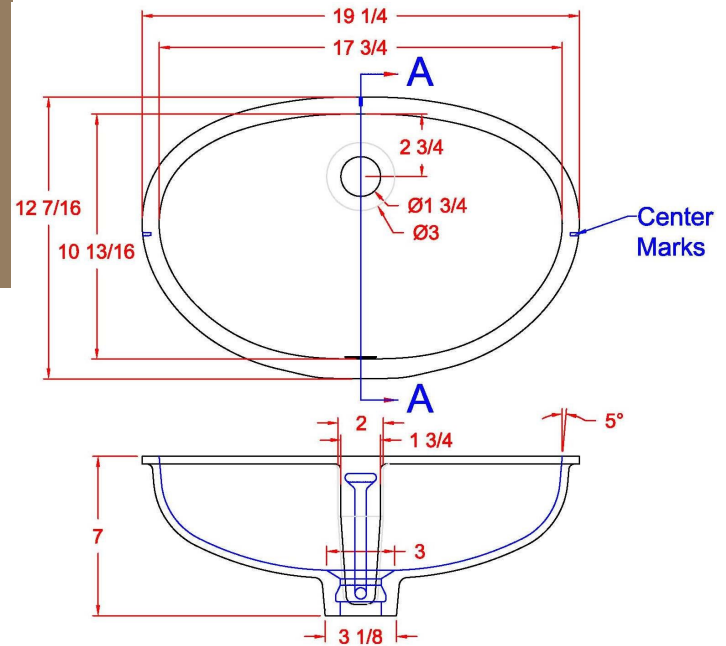

Front View

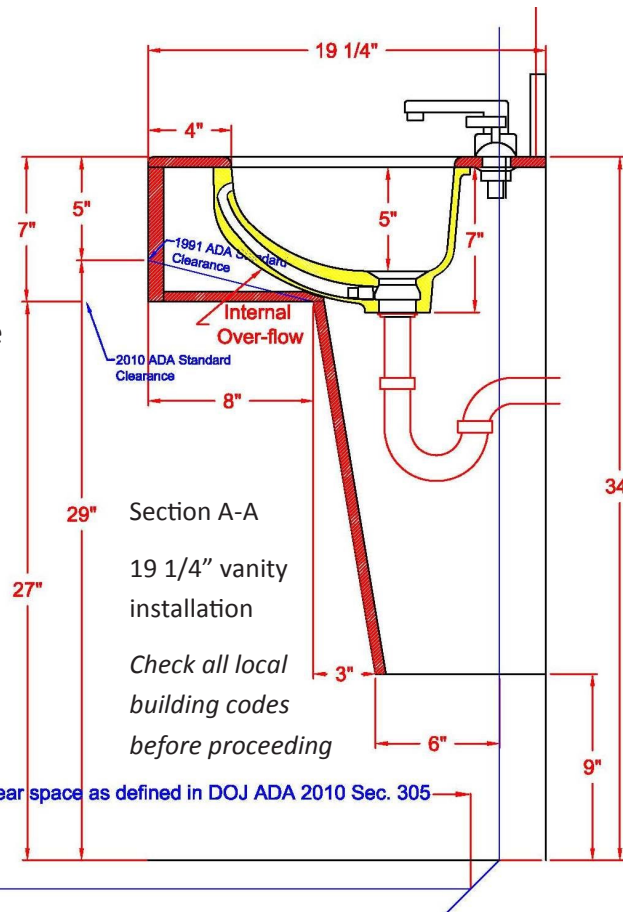

Home Innovation
LAB CERTIFIED™

UL
LISTED

1729-D Kitchen Sink

1729-D Double Bowl

I.D.: 29" x 16 11/16"

Depth: 9"*

*Depth does not include counter top thickness

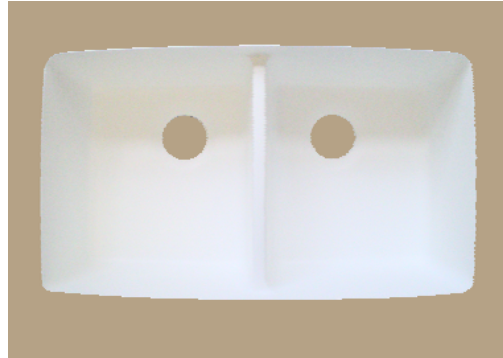

The **Gemstone** 1729-D is Gemstone's redesigned 3119-D model. The tighter radii, sleek curves, steeper side walls, and narrower sink divider offers nearly 22% more usable floor space at the bottom of the sink. The offset drains allow the sink to drain better when dishes are in the sink. The lowered divider bar offers an aesthetic improvement to the sink as well as easier routing and sanding for the fabricator. This redesigned European style double equal kitchen sink provides a seamless kitchen sink in any solid surface sheet material, acrylic, polyester or blended. This sink fits well in a 36" cabinet.

Gemstone Sinks are compatible and warranted when used with all major solid surface sheet brands with the same sheet

Gemstone supports conservation and green building practices and may contribute toward achieving LEED® building certification in commercial projects. All Gemstone Sinks use resin containing 15% post-consumer recycled content and 5.5% rapidly renewable materials.

Gemstone sinks are proudly made in the USA.

Gemstone sinks are certified by: **NAHB** (ANSI Z124.3)

UL in the US and Canada (ANSI Z124.3 & B45.0-99)

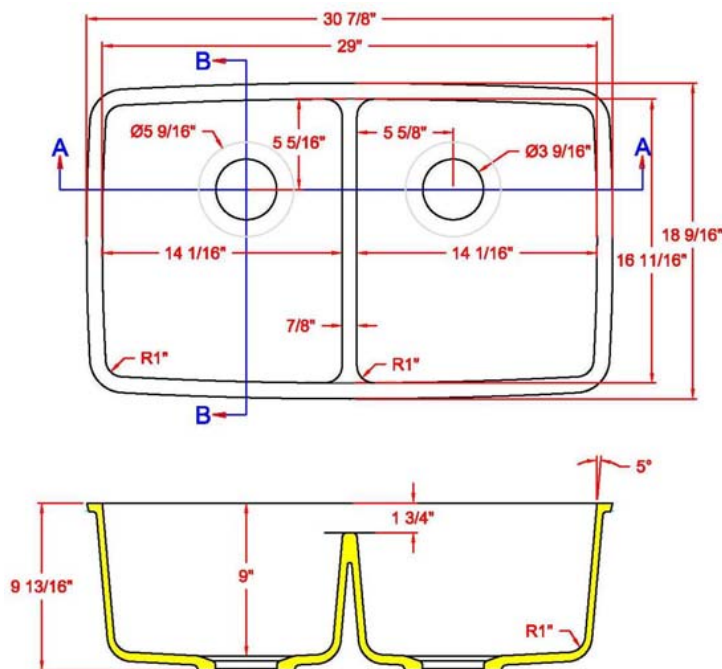

Section A-A

2015-S Single Bowl Sink

2015-S Single Bowl

I.D.: 20 3/8" x 15 5/8"

Depth: 8 1/2"*

*Depth does not include counter top thickness



The **Gemstone** 2015-S Single Bowl Sink provides a seamless kitchen/utility or laboratory sink in any solid surface sheet material, acrylic, polyester or blended. This sink fits well in a 30" cabinet and is ideal for a space saving kitchen.

Gemstone Sinks are compatible and warranted when used with all major solid surface sheet brands with the same sheet warranties.

 **Gemstone** supports conservation and green building practices and may contribute toward achieving LEED® building certification in commercial projects. All Gemstone Sinks use resin containing 15% post-consumer recycled content and 5.5% rapidly renewable materials.

 **Gemstone** sinks are proudly made in the USA.

Gemstone sinks are certified by: **NAHB** (ANSI Z124.6)

UL in the US and Canada (ANSI Z124.6 & B45.0-99)

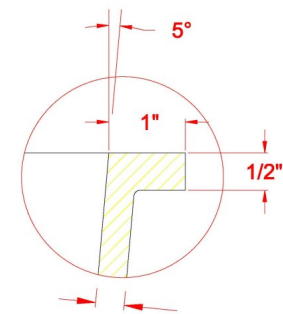
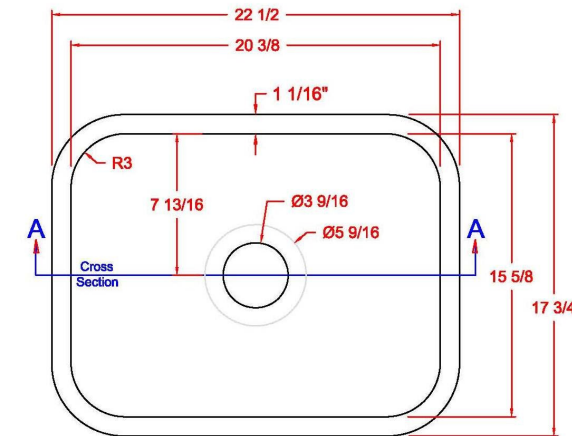

Flange Detail

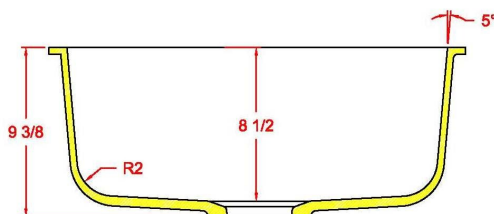

Section A-A

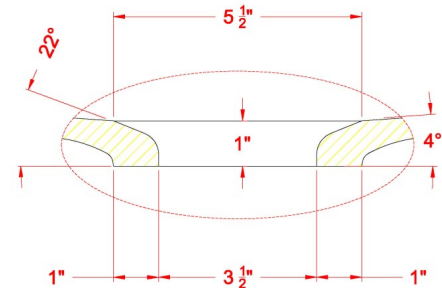

Drain Detail

2917-D Kitchen Sink

2917-D Double Bowl

I.D.: 29" x 16 11/16"

Depth: 9"*

*Depth does not include counter top thickness



The **Gemstone** 2917-D is Gemstone's newest design. With tighter radii, sleek curves, steeper side walls, and narrower sink divider offers more usable floor space at the bottom of the sink than other models. This sink is reversible so the small sink can be on the left or right. The lowered divider bar offers an aesthetic improvement to the sink as well as easier routing and sanding for the fabricator. This European style double equal kitchen sink provides a seamless kitchen sink in any solid surface sheet material, acrylic, polyester or blended. This sink fits well in a 36" cabinet.

Gemstone Sinks are compatible and warranted when used with all major solid surface sheet brands with the same sheet warranties.

Gemstone supports conservation and green building practices and may contribute toward achieving LEED® building certification in commercial projects. All Gemstone Sinks use resin containing 15% post-consumer recycled content and 5.5% rapidly renewable materials.

Gemstone sinks are proudly made in the USA.

Gemstone sinks are certified by: **NAHB** (ANSI Z124.6)

UL in the US and Canada (ANSI Z124.6 & B45.0-99)

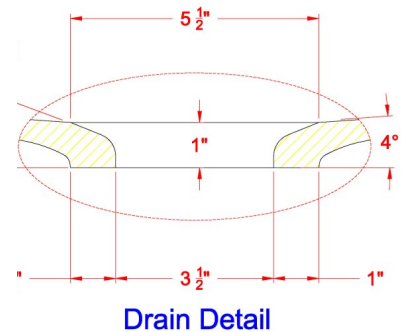
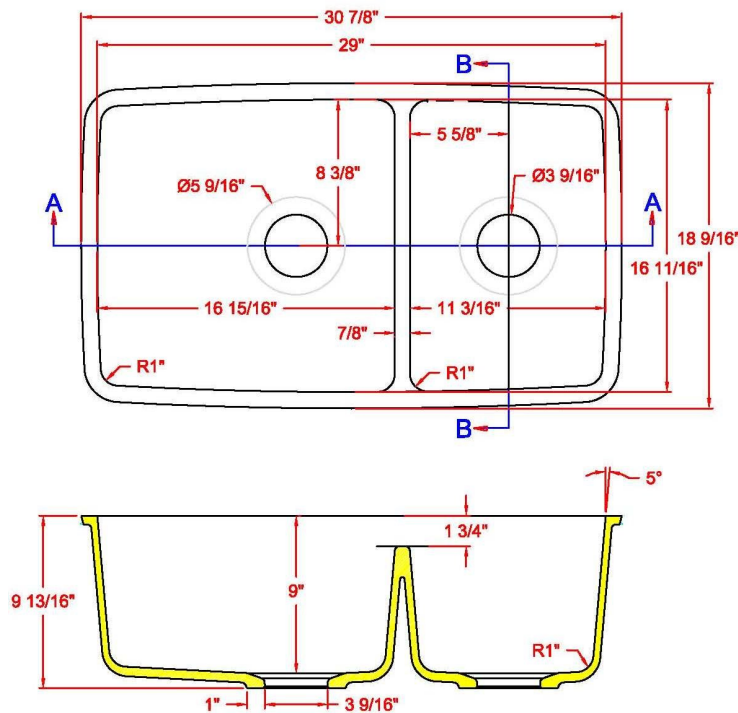

Section A-A

Drain Detail



P R O J E C T I N S P I R E D

A JOURNAL OF CREATIVE THINKING
ABOUT SOLID SURFACES.

SIGN UP FOR THE NEWSLETTER AT:

www.HARDWAREIMAGINATION-TECH.com.



Hanex[®] Solid Surfaces

by Hanwha Surfaces



TO ORDER SAMPLES OR VIEW
OUR COLLECTIONS VISIT:

HARDWAREIMAGINATION-TECH.COM



Miami, FL :: 305-635-3300

Pompano Beach :: 954-581-0444

Tampa, FL :: 813-882-0322

Roanoke, Va :: 540-986-2200

Raleigh, NC :: 919-424-7481

Sarasota, FL :: 941-371-5238

Orlando, FL :: 407-855-2282

West Palm, FL :: 561-844-2277

Thomasville NC :: 336-476-0200

Gastonia, NC :: 704-917-0490