

SOFT CLOSE HINGES



110° Soft Close Snap-On Hinge



90° Soft Close



45° Soft Close

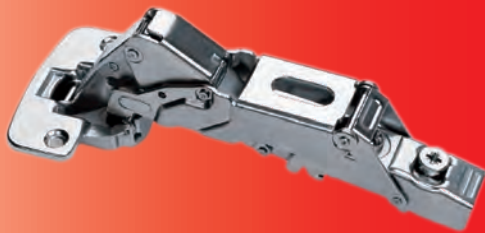

155° Soft Close



Full Overlay Soft Close



Inset Soft Close



Half Overlay Soft Close

SOFT CLOSE HINGES

Economy Soft Close

**CAM ADJUSTABLE
HINGE ARM**

Kitchens

110° Soft Close Snap-On Hinge

Doors

- Snap-On Hinge
- Soft Close Cylinder Inside Hinge Arm
- 35mm Cup
- 45mm Drilling Pattern
- All Steel Construction
- *Satisfaction Guaranteed*

Kitchen
Accessories

Hinges

Drawer
Slides

Plywood
Melamine

Veneer
Edgebanding

Laminate

Solid
Surface

Closets

Furniture
Hardware

Pulls
&
Knobs



Item Number	Description
14-400	110° Soft Close Snap-on Hinge without Dowels
14-402	110° Soft Close Snap-on Hinge with Dowels

Lighting

Grommets

Locks,
Lock
Systems

Molding,
Carvings



Full overlay C=0

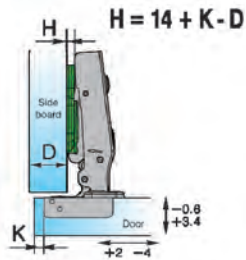

**SOFT CLOSE FULL OVERLAY
HINGE 14-400**

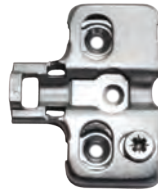

**ADJUSTABLE
2 PIECE PLATE**

FACE FRAME PLATE

1 PIECE PLATE

0mm PLATE
WITHOUT SCREWS
14-216

1mm PLATE
WITHOUT SCREWS
14-224

0mm PLATE
WITHOUT SCREWS
14-228

2mm PLATE
WITHOUT SCREWS
14-218

3mm PLATE
WITHOUT SCREWS
14-226

2mm PLATE
WITHOUT SCREWS
14-230

0mm PLATE
WITH EURO SCREWS
14-220

2mm PLATE
WITH EURO SCREWS
14-222



Tools

Adhesives
Solvents
Abrasives

Chemicals
Staples
Screws

SOFT CLOSE HINGES

Soft Close

110° Soft Close Snap-On Hinge

- Snap-On Hinge
- Soft Close Cylinder Inside Hinge Arm
- 35mm Cup
- 45mm Drilling Pattern
- All Steel Construction
- *Satisfaction Guaranteed*

Kitchens
Doors
Kitchen Accessories
Hinges

Drawer Slides
Plywood Melamine
Veneer Edgbanding
Laminate
Solid Surface
Closets

Furniture Hardware
Pulls & Knobs
Lighting

Grommets
Locks, Lock Systems
Molding, Carvings
Tools

Adhesives Solvents Abrasives
Chemicals Staples Screws



ADJUSTABLE 2 PIECE PLATE

FACE FRAME PLATE

1 PIECE PLATE

0mm PLATE WITHOUT SCREWS 14-216
2mm PLATE WITHOUT SCREWS 14-218
0mm PLATE WITH EURO SCREWS 14-220
2mm PLATE WITH EURO SCREWS 14-222

1mm PLATE WITHOUT SCREWS 14-224
3mm PLATE WITHOUT SCREWS 14-226

0mm PLATE WITHOUT SCREWS 14-228
2mm PLATE WITHOUT SCREWS 14-230

FULL OVERLAY
HINGE WITH DOWELS
14-306

FULL OVERLAY
HINGE **14-302**

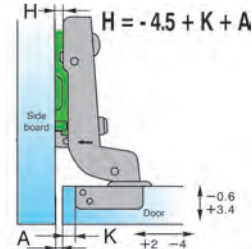
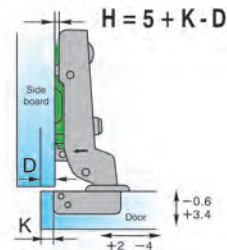
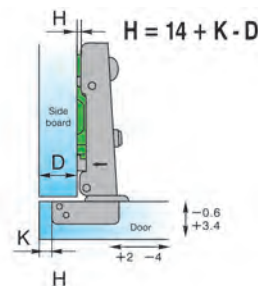

HALF OVERLAY
HINGE **14-304**

INSET OVERLAY
HINGE **14-308**

CAM ADJUSTABLE HINGE ARM

SOFT CLOSE HINGES

Speciality Soft Close

Kitchens

Doors

Kitchen Accessories

Hinges

Drawer Slides

Plywood Melamine

Veneer Edgbanding

Laminate

Solid Surface

Closets

Furniture Hardware

Pulls & Knobs

Lighting

Grommets

Locks, Lock Systems

Molding, Carvings

Tools

Adhesives Solvents Abrasives

Chemicals Staples Screws

- 45° & 90° Soft Close Snap-On Hinge
- Snap-On Hinge
- Soft Close Cylinder Inside Hinge Arm
- 35mm Cup
- 45mm Drilling Pattern
- No Dowels
- *Satisfaction Guaranteed*

CAM ADJUSTABLE HINGE ARM



FACE FRAME PLATE	1 PIECE PLATE	ADJUSTABLE 2 PIECE PLATE
1mm PLATE WITHOUT SCREWS 14-224	0mm PLATE WITHOUT SCREWS 14-228	0mm PLATE WITHOUT SCREWS 14-216
3mm PLATE WITHOUT SCREWS 14-226	2mm PLATE WITHOUT SCREWS 14-230	2mm PLATE WITHOUT SCREWS 14-218
		0mm PLATE WITH EURO SCREWS 14-220
		2mm PLATE WITH EURO SCREWS 14-222

45° FULL OVERLAY



Item Number 14-404

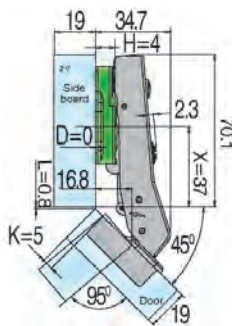

Adjustment range of L
-0.6 — +3.4

Adjustment range of D
+2.0 — -4.0

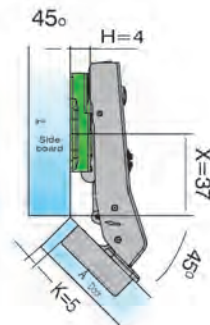

90° FULL OVERLAY

Item Number 14-406



90°

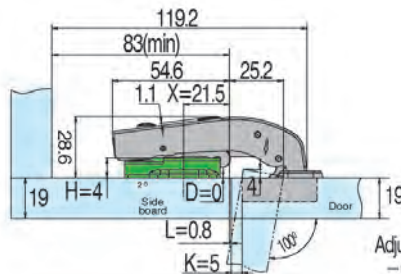

Adjustment range of D
-3.3 — +2.7

Adjustment range of L
-0.6 — +3.4

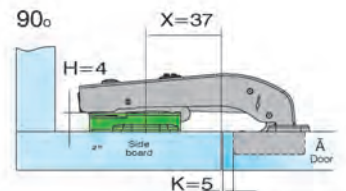

SOFT CLOSE HINGES

Speciality Soft Close

**CAM ADJUSTABLE
HINGE ARM**

155° Soft Close Snap-On Hinge

- Snap-On Hinge
- Soft Close Cylinder Inside Hinge Arm
- 35mm Cup
- 45mm Drilling Pattern
- No Dowels
- *Satisfaction Guaranteed*



FACE FRAME PLATE

1mm PLATE
WITHOUT SCREWS
14-224

3mm PLATE
WITHOUT SCREWS
14-226



1 PIECE PLATE

0mm PLATE
WITHOUT SCREWS
14-228

2mm PLATE
WITHOUT SCREWS
14-230



ADJUSTABLE
2 PIECE PLATE

0mm PLATE
WITHOUT SCREWS
14-216

2mm PLATE
WITHOUT SCREWS
14-218

0mm PLATE
WITH EURO SCREWS
14-220

2mm PLATE
WITH EURO SCREWS
14-222



Full overlay C=0

FULL OVERLAY

Item Number **14-408**

H=0
90° 2.3mm,

The door combined with a mounting plate H=0, opens at 90° with a 2.3mm protrusion allowing inner drawers to be pulled out from inside of the cabinet.

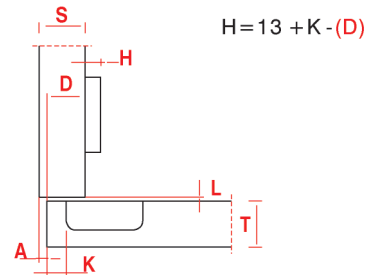
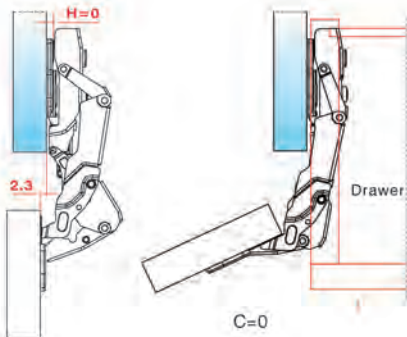

Kitchens

Doors

Kitchen
Accessories

Hinges

Drawer
Slides

Plywood
Melamine

Veneer
Edgebanding

Laminate

Solid
Surface

Closets

Furniture
Hardware

Pulls
&
Knobs

Lighting

Grommets

Locks,
Lock
Systems

Molding,
Carvings

Tools

Adhesives
Solvents
Abrasives

Chemicals
Staples
Screws

SNAP-ON HINGES

110° Screw-On Hinge

Kitchens

Doors

Kitchen Accessories

Hinges

Drawer Slides

Plywood Melamine

Veneer Edgebanding

Laminate

Solid Surface

Closets

Furniture Hardware

Pulls & Knobs

Lighting

Grommets

Locks, Lock Systems

Molding, Carvings

Tools

Adhesives Solvents Abrasives

Chemicals Staples Screws

- Self Closing
- 35mm Cup
- 45mm Boring Pattern
- All Steel Construction



Order Number	Description
14-101	110° Screw-on Hinge



1 PIECE PLATE

0mm PLATE
WITH EURO SCREWS
14-213



1 PIECE PLATE

0mm PLATE
WITHOUT SCREWS
14-215

SNAP-ON HINGES

110° Snap-On Hinge

- Self Closing
- 35mm Cup
- 45mm Boring Pattern
- All Steel Construction



Cover cap not included

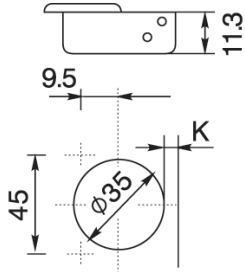

1 PIECE PLATE

0mm PLATE WITHOUT SCREWS 14-200
2mm PLATE WITHOUT SCREWS 14-202
0mm PLATE WITH EURO SCREWS 14-205
2mm PLATE WITH EURO SCREWS 14-207



FACE FRAME

0mm PLATE FOR 5/8" OVERLAY 14-212
4mm PLATE FOR 1/2" OVERLAY 14-214



2 PIECE PLATE

0mm PLATE WITHOUT SCREWS 14-204
2mm PLATE WITHOUT SCREWS 14-206
0mm PLATE WITH EURO SCREWS 14-209
2mm PLATE WITH EURO SCREWS 14-211

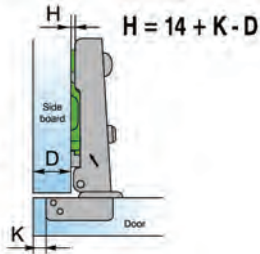

FULL OVERLAY
HINGE 14-100

FULL OVERLAY
HINGE WITH DOWELS
14-102

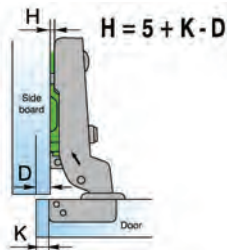

HALF OVERLAY
HINGE 14-104

HALF OVERLAY
HINGE WITH DOWELS
14-106

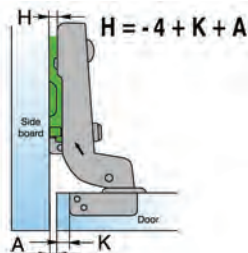

INSET OVERLAY
HINGE 14-108

Kitchens

Doors

Kitchen Accessories

Hinges

Drawer Slides

Plywood Melamine

Veneer Edgbanding

Laminate

Solid Surface

Closets

Furniture Hardware

Pulls & Knobs

Lighting

Grommets

Locks, Lock Systems

Molding, Carvings

Tools

Adhesives Solvents Abrasives

Chemicals Staples Screws

SNAP-ON HINGES

30°, 45° & 90° Snap-On Hinge

Kitchens

Doors

Kitchen
Accessories

Hinges

Drawer
Slides

Plywood
Melamine

Veneer
Edgebanding

Laminate

Solid
Surface

Closets

Furniture
Hardware

Pulls
&
Knobs

Lighting

Grommets

Locks,
Lock
Systems

Molding,
Carvings

Tools

Adhesives
Solvents
Abrasives

Chemicals
Staples
Screws

- Self Closing
- 35mm Cup
- 45mm Boring Pattern
- All Steel Construction



30° FULL OVERLAY

HINGE WITH DOWELS

14-130



45° FULL OVERLAY

HINGE WITH DOWELS

14-132



90° FULL OVERLAY

HINGE WITH DOWELS

14-134



1 PIECE PLATE

0mm PLATE
WITHOUT SCREWS
14-200

2mm PLATE
WITHOUT SCREWS
14-202

0mm PLATE
WITH EURO SCREWS
14-205

2mm PLATE
WITH EURO SCREWS
14-207



FACE FRAME

0mm PLATE FOR
5/8" OVERLAY
14-212

4mm PLATE FOR
1/2" OVERLAY
14-214



2 PIECE PLATE

0mm PLATE
WITHOUT SCREWS
14-204

2mm PLATE
WITHOUT SCREWS
14-206

0mm PLATE
WITH EURO SCREWS
14-209

2mm PLATE
WITH EURO SCREWS
14-211

SNAP-ON HINGES

125° Full Access Snap-On Hinge

125 Full Overlay / Dowels
and CAM Adjustment
14-120



**CAM ADJUSTABLE
HINGE ARM**



1 PIECE PLATE

0mm PLATE WITHOUT SCREWS 14-200
2mm PLATE WITHOUT SCREWS 14-202
0mm PLATE WITH EURO SCREWS 14-205
2mm PLATE WITH EURO SCREWS 14-207



FACE FRAME

0mm PLATE FOR 5/8" OVERLAY 14-212
4mm PLATE FOR 1/2" OVERLAY 14-214



2 PIECE PLATE

0mm PLATE WITHOUT SCREWS 14-204
2mm PLATE WITHOUT SCREWS 14-206
0mm PLATE WITH EURO SCREWS 14-209
2mm PLATE WITH EURO SCREWS 14-211

Kitchens

Doors

Kitchen
Accessories

Hinges

Drawer
Slides

Plywood
Melamine

Veneer
Edgebanding

Laminate

Solid
Surface

Closets

Furniture
Hardware

Pulls
&
Knobs

Lighting

Grommets

Locks,
Lock
Systems

Molding,
Carvings

Tools

Adhesives
Solvents
Abrasives

Chemicals
Staples
Screws

SNAP-ON HINGES

165° Snap-On Hinge

Kitchens

Doors

Kitchen Accessories

Hinges

Drawer Slides

Plywood Melamine

Veneer Edgebanding

Laminate

Solid Surface

Closets

Furniture Hardware

Pulls & Knobs

Lighting

Grommets

Locks, Lock Systems

Molding, Carvings

Tools

Adhesives Solvents Abrasives

Chemicals Staples Screws

- Self Closing
- 35mm Cup
- 45mm Boring Pattern
- All Steel Construction
- Clip-On Hinge



Inset C=15

Order Number	Description
14-139	165° Snap-on Hinge with Dowels

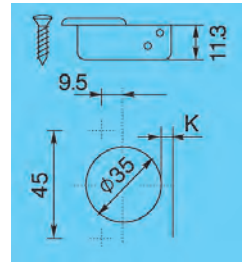
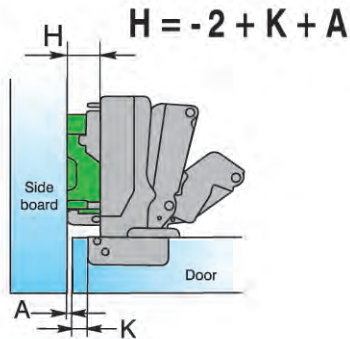

DRILLING DISTANCE

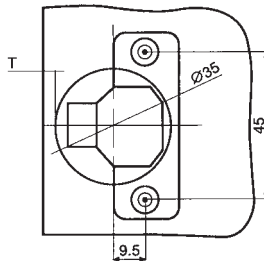
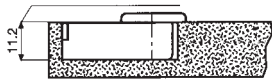

1 PIECE PLATE

0mm PLATE WITHOUT SCREWS 14-200
2mm PLATE WITHOUT SCREWS 14-202
0mm PLATE WITH EURO SCREWS 14-205
2mm PLATE WITH EURO SCREWS 14-207



FACE FRAME

0mm PLATE FOR 5/8" OVERLAY 14-212
4mm PLATE FOR 1/2" OVERLAY 14-214



2 PIECE PLATE

0mm PLATE WITHOUT SCREWS 14-204
2mm PLATE WITHOUT SCREWS 14-206
0mm PLATE WITH EURO SCREWS 14-209
2mm PLATE WITH EURO SCREWS 14-211

SNAP-ON HINGES

Pie Cut Free Swing Snap-On Hinge

- Self Closing
- 35mm Cup
- 45mm Boring Pattern
- All Steel Construction

**PIE CUT FREE SWING
HINGE WITH DOWELS**
14-138



1 PIECE PLATE

**0mm PLATE
WITHOUT SCREWS**
14-200

**2mm PLATE
WITHOUT SCREWS**
14-202

**0mm PLATE
WITH EURO SCREWS**
14-205

**2mm PLATE
WITH EURO SCREWS**
14-207



FACE FRAME

**0mm PLATE FOR
5/8" OVERLAY**
14-212

**4mm PLATE FOR
1/2" OVERLAY**
14-214



2 PIECE PLATE

**0mm PLATE
WITHOUT SCREWS**
14-204

**2mm PLATE
WITHOUT SCREWS**
14-206

**0mm PLATE
WITH EURO SCREWS**
14-209

**2mm PLATE
WITH EURO SCREWS**
14-211

Kitchens

Doors

Kitchen
Accessories

Hinges

Drawer
Slides

Plywood
Melamine

Veneer
Edgebanding

Laminate

Solid
Surface

Closets

Furniture
Hardware

Pulls
&
Knobs

Lighting

Grommets

Locks,
Lock
Systems

Molding,
Carvings

Tools

Adhesives
Solvents
Abrasives

Chemicals
Staples
Screws

SELF / SOFT CLOSE HINGES

Tiomos Hinge

Kitchens

Tiomos, a completely new hinge system.

Doors

With the new Tiomos hinge, Grass opens a new chapter in functional hardware which will inspire cabinet makers of the future. Years of research have been dedicated in developing the next generation of Concealed hinges making sure that every detail, every function, and every mechanism is in perfect unison with each other. The result is excellence in a hinge system which meets and surpasses the technical and functional requirements of tomorrow's hardware.

Kitchen Accessories

Hinges

Drawer Slides

Plywood Melamine

Veneer Edgebanding

Laminate

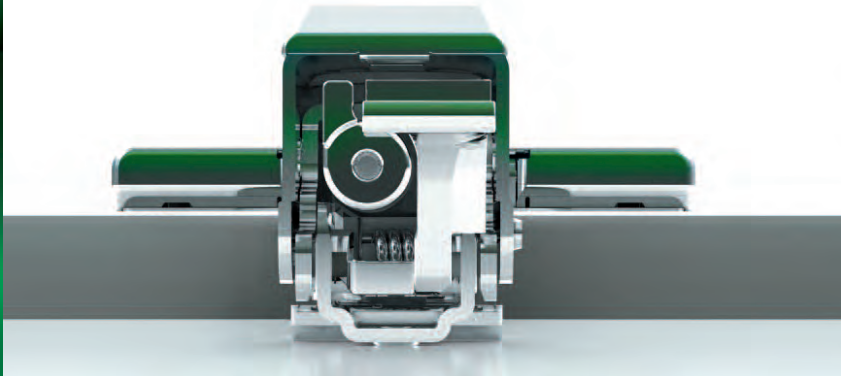

It's simply genius.

Solid Surface

One of the favored characteristics of the new Tiomos hinge system is the Soft-Close; Grass' unique adjustable closing mechanism, which is fully integrated and Concealed in the hinge arm. The closing process is extremely smooth from the degree that the Soft-close is activated until the door is completely shut. With our superb engineering and design, size and weight of the door will not be a factor. The Tiomos hinge system maintains the stability that surpasses all other hinges on the market. The cabinet doors pull open with ease and minimal gaps can be achieved with the new design of the hinge.

Closets

Furniture Hardware



Pulls & Knobs

Lighting

Tool-less Soft-Close adjustment

Soft-closing performance can be regulated for any door size and weight with the Tiomos adjustable integrated Soft-close. Depending upon the requirement, the Soft-closing settings can be adjusted easily and without tools. With 2 hinges there are 6 Soft-close settings.

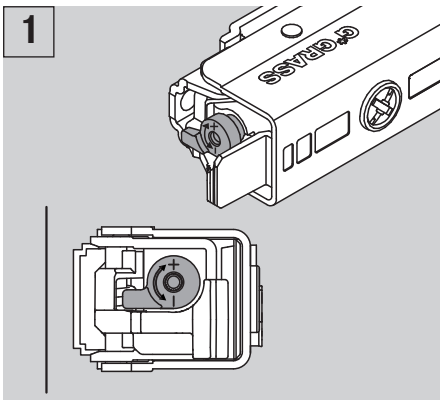

Light setting
Adjustment lever points toward the cabinet wall
Appropriate for:
• Small, light doors

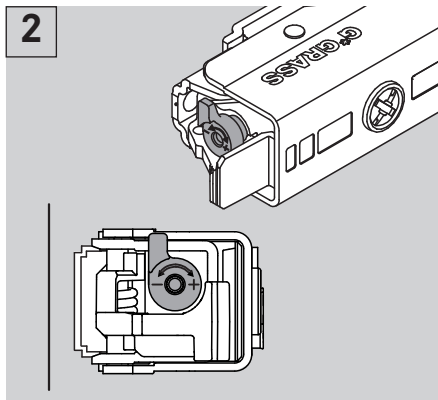

Medium setting (factory setting)
Adjustment lever is parallel to the cabinet wall. This setting covers 80% of door applications.
Appropriate for:
• Standard doors

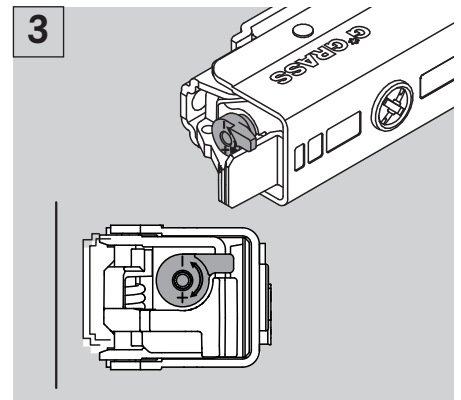

Strong setting
Adjustment lever points toward the cabinet interior
Appropriate for:
• Large, heavy doors

Locks, Lock Systems

Molding, Carvings

Tools

Adhesives Solvents Abrasives

Chemicals Staples Screws

SELF / SOFT CLOSE HINGES

Tiomos Click-on 110°

Description

- 110° Hinge For Standard Doors
- 3-Dimensional Adjustment With Suitable Base Plate
- Accommodates Overlays Up To 19mm (7/8")
- Optimal Reveal Up To 24 mm Door Thickness
- Soft-Close Or Self-Close Hinges Available
- For Face Frame Or Frameless Cabinets
- Comfortable Depth Adjustment With Threaded Screw



Drawings Show Tiomos With Base Plate, Height 02.

Full Overlay

Cranking 00

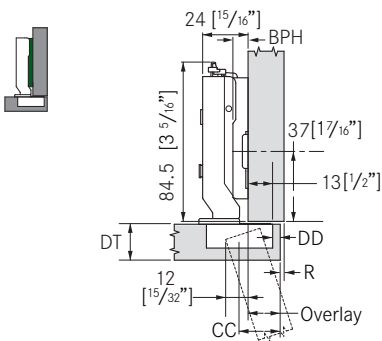

- Self-Close Screw-on..... 12-610
- Self-Close Dowels 12-611
- Soft-Close Screw-on 12-600
- Soft-Close Dowels..... 12-601

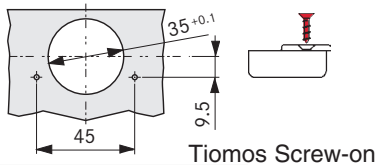

Half Overlay

Cranking 9.5

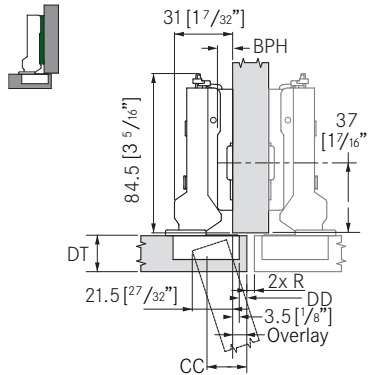

- Self-Close Screw-on..... 12-612
- Soft-Close Screw-on 12-602

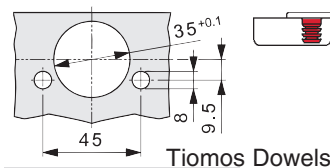

Inset

Cranking 19

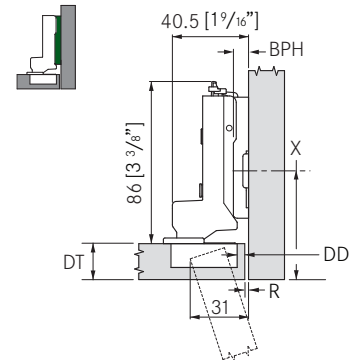

- Self-Close Screw-on..... 12-614
- Self-Close Dowels *12-615
- Soft-Close Screw-on 12-604
- Soft-Close Dowels..... *12-605

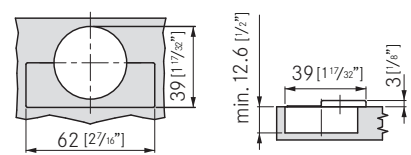

Tiomos Wing Steel Base Plate, 3 Point Fixing

Description

- Steel, Nickel Plated
- Height And Depth Adjustment Via Worm Gear
- Side Adjustment Via Hinge

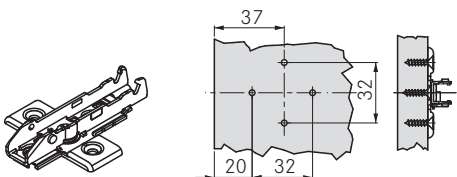

• Height adjustment via worm gear

- 0mm Screw-on..... 12-964
- 2mm Screw-on..... 12-965

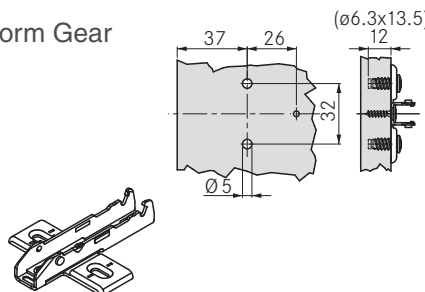

• Height adjustment via elongated screw holes

- 0mm Screw-on..... 12-960
- 2mm Screw-on..... 12-962

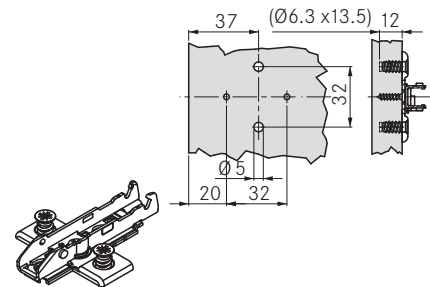

• Height adjustment via worm gear

- 0mm Euro Screw 12-961
- 2mm Euro Screw 12-963

Kitchens

Doors

Kitchen Accessories

Hinges

Drawer Slides

Plywood Melamine

Veneer Edgebanding

Laminate

Solid Surface

Closets

Furniture Hardware

Pulls & Knobs

Lighting

Grommets

Locks, Lock Systems

Molding, Carvings

Tools

Adhesives Solvents Abrasives

Chemicals Staples Screws

SELF / SOFT CLOSE HINGES

Tiomos Impresso 110°



Kitchens

Doors

Kitchen Accessories

Hinges

Drawer Slides

Plywood Melamine

Veneer Edgebanding

Laminate

Solid Surface

Closets

Furniture Hardware

Pulls & Knobs

Lighting

Grommets

Locks, Lock Systems

Molding, Carvings

Tools

Adhesives Solvents Abrasives

Chemicals Staples Screws

Description

110° Hinge For Standard Doors

- 3-dimensional adjustment with suitable base plate
- Accommodates overlays up to 24mm (15/16")
- Optimal reveal up to 24 mm door thickness
- Soft-close or Self-close hinges available
- For face frame or frameless cabinets
- Convenient depth adjustment with worm gear

Full Overlay

Cranking 03

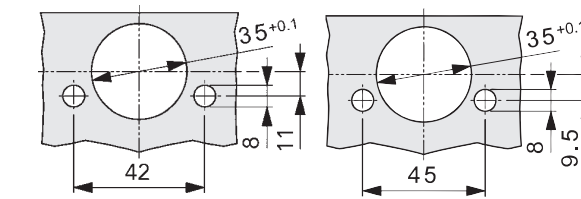
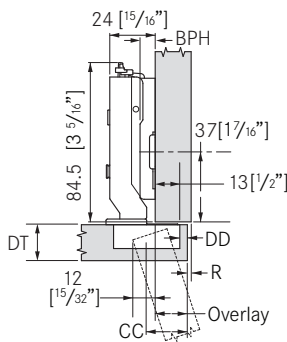

Drawings Show Tiomos With Base Plate, Height 02.

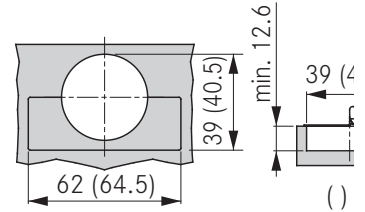

Self-Close 110° Impresso *12-643
Soft-Close 110° Impresso *12-642

Tiomos Click-on 120°

Description

120° Hinge For Standard Doors

- 3-Dimensional Adjustment With Suitable Base Plate
- Accommodates Overlays Up To 22mm (7/8")
- Optimal Reveal Up To 24 mm Door Thickness
- Soft-Close Or Self-Close Hinges Available
- For Face Frame Or Frameless Cabinets
- Comfortable Depth Adjustment With Threaded Screw



Cranking 00

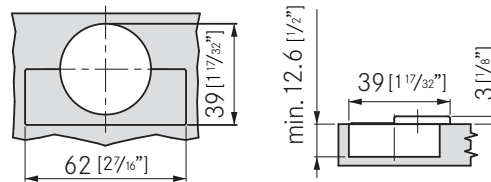
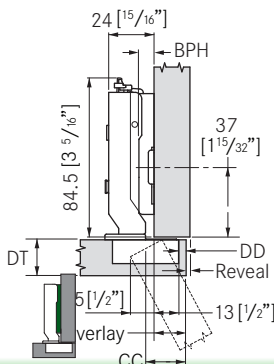

Drawings Show Tiomos With Base Plate, Height 02.

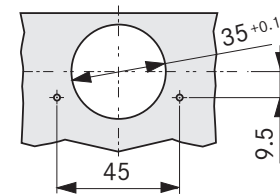

Self-Close 120° Screw-on 12-620
Soft-Close 120° Screw-on 12-630

SELF / SOFT CLOSE HINGES



Tiomos Click-on 160°

Description

160° Wide Angle Hinge

- 3-dimensional adjustment with suitable base plate
- Accommodates overlays up to 25.4 mm (1")
- Soft-close or Self-close hinges available
- For face frame or frameless cabinets
- Convenient depth adjustment with worm gear
- Zero protrusion when door is opened 90°
- 10mm cup depth
- For door thicknesses up to 32 mm (1 1/4")
- Minimal reveal

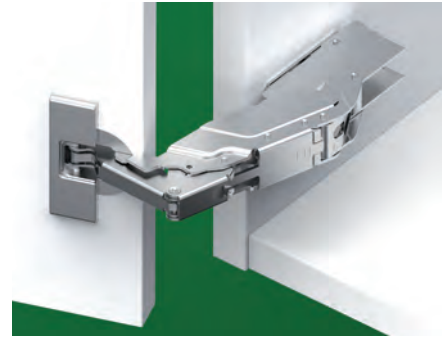

Full Overlay

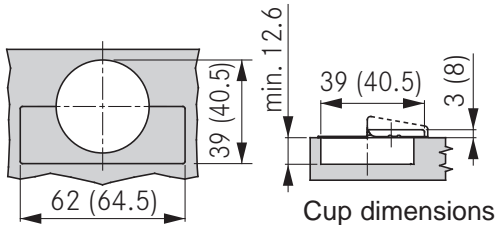

Self-Close 160° Screw-on..... **12-660**
 Self-Close 160° Dowels..... ***12-654**

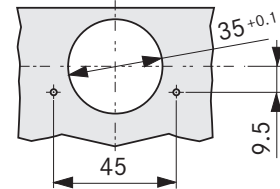
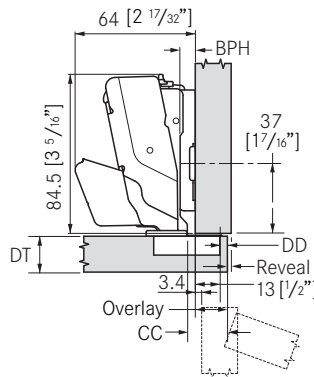

Soft-Close 160° Screw-on..... **12-650**
 Soft-Close 160° Dowels **12-652**
 Soft-Close 160° Impresso ***12-645**

Tiomos 110°/+45° Angle Corner

Description

+45° Angle Corner Cabinet Hinge For Overlay Doors

- For 45° Angle Corner Cabinets
- 110° Opening Angle
- 3-Dimensional Adjustment With Suitable Base Plate
- Soft-Close Or Self-Close Hinges Available
- Convenient Depth Adjustment With Worm Gear

Soft-Close 110°/+45° Screw-on.....**12-670**
 Soft-Close 110°/+45° Screw-on w/Dowels.....**12-672**
 Self-Close 110°/+45° Screw-on.....**12-674**
 Self-Close 110°/+45° Screw-on w/Dowels.....**12-676**

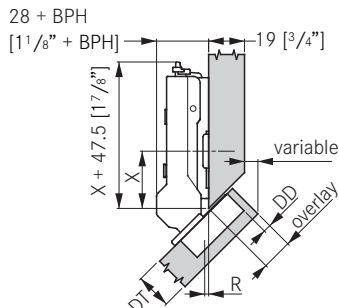
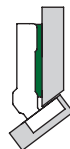
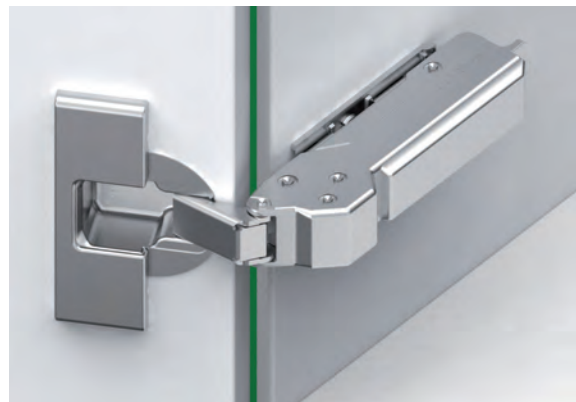

Drawing shows Tiomos with a base plate height (BPH) 0.

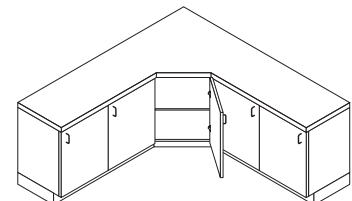
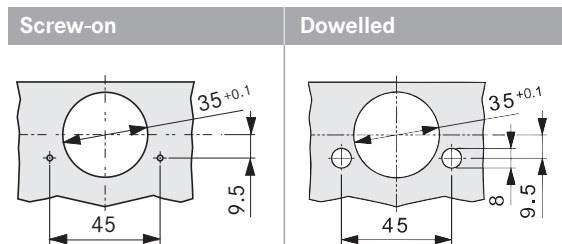

Item Stocked in Roanoke, VA Only ~ All other locations available through Special Order.

Kitchens

Doors

Kitchen Accessories

Hinges

Drawer Slides

Plywood Melamine

Veneer Edgbanding

Laminate

Solid Surface

Closets

Furniture Hardware

Pulls & Knobs

Lighting

Grommets

Locks, Lock Systems

Molding, Carvings

Tools

Adhesives Solvents Abrasives

Chemicals Staples Screws

SELF / SOFT CLOSE HINGES

Tiomos 110°/90° Blind Corner

Kitchens

Description

Doors 110° Blind Corner Hinge For Overlay Doors

- For Blind Corner Construction
- 110° Opening Angle
- 3-Dimensional Adjustment With Suitable Base Plate
- Soft-Close Or Self-Close Hinges Available
- Convenient Depth Adjustment With Worm Gear

Soft-Close Screw-on.....12-678

Soft-Close Screw-on w/Dowels.....12-680

Self-Close Screw-on.....12-682

Self-Close Screw-on w/Dowels.....12-684

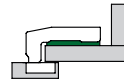

Kitchen Accessories

Hinges

Drawer Slides

Plywood Melamine

Veneer Edgebanding

Laminate

Solid Surface

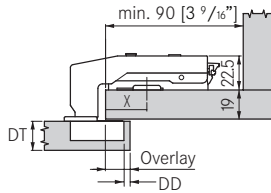

Drawing shows Tiomos with a base plate height (BPH) 03.

Screw-on

Dowelled

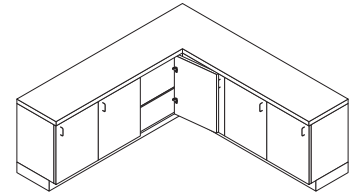
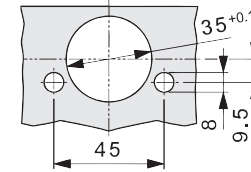
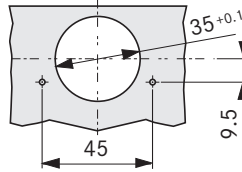

Closets

Tiomos PCC

Furniture Hardware

Description

Pie-Cut Corner Cabinet Hinge

- 3-Dimensional Adjustment With Suitable Base Plate
- Designed For Connecting Two Folding Doors In Corner Cabinet
- For Door Thicknesses 16 To 22 Mm
- Self-Close Hinges Available
- Used In Conjunction With Tiomos 160 Hinges

Self-Close Screw-on..... 12-686

Self-Close w/Dowels 12-688

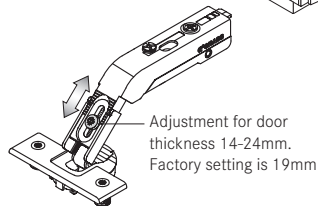
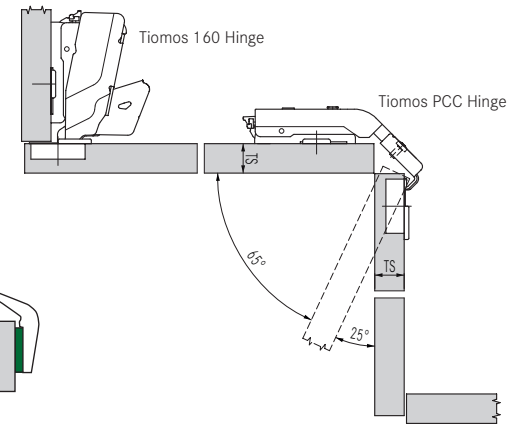
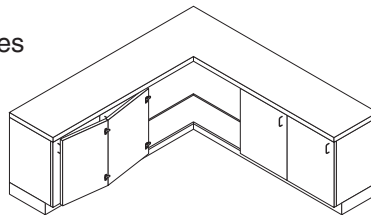

Grommets

Locks, Lock Systems

Molding, Carvings

Tools

Adhesives Solvents Abrasives

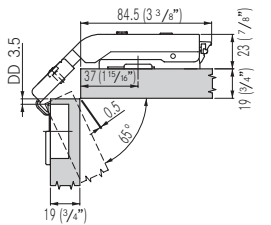

19mm door thickness with base plate height 0

Screw-on

Dowelled

Cup dimensions

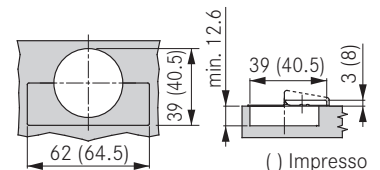
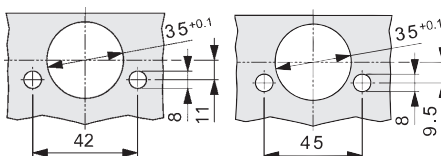
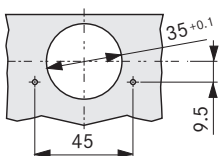

() Impresso

Description

- 3-dimensional adjustment with suitable base plate
- Soft-close compatible
- Shallow cup depth
- Nexis 11 mm
- Accommodates overlays up to 20mm (25/32")
- Self-close or free-swing hinges available
- For face frame and frameless cabinets
- Combination drilling pattern for Nexis Impresso



Full overlay

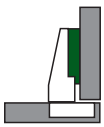

Cranking 00



- Self-closing Screw-on..... **12-721**
- Self-closing Dowels **12-726**
- Free Swing Screw-on..... **12-706**
- Free Swing Dowels..... **12-701**

Half overlay

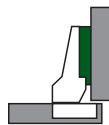

Cranking 08



- Self-closing Screw-on..... **12-714**
- Self-closing Dowels **12-727**

Inset



Cranking 15



- Self-closing Screw-on..... **12-724**
- Self-closing Dowels **12-720**
- Free Swing Dowels..... **12-722**
- Free Swing Screw-On **12-712**

Full Overlay

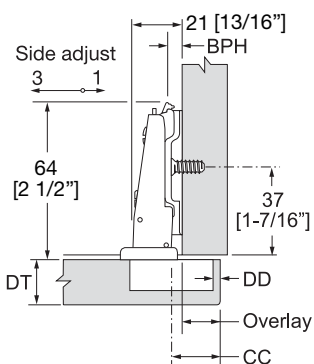

Drawings show mounting plate, thickness 02.

Half Overlay

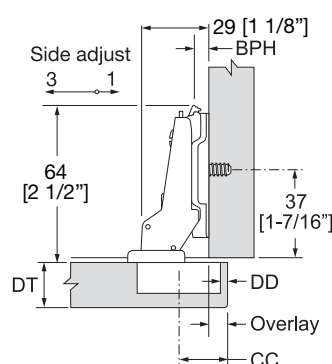

Drawings show mounting plate, thickness 02.

Inset

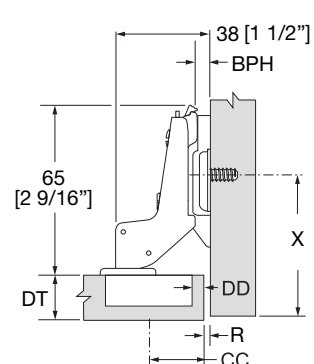

Drawings show mounting plate, thickness 04.

Nexis

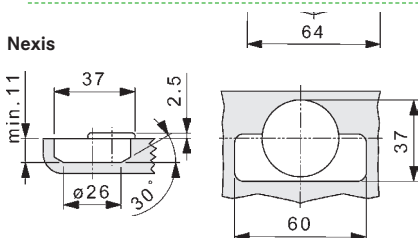

Adjustment

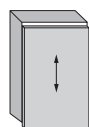

Height adjustment
±2 mm

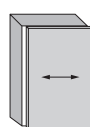

Side adjustment
+1/-3 mm

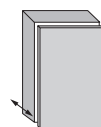

Depth adjustment
+3/-1 mm

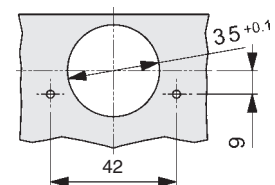

SNAP-ON HINGES

Nexis Hinge 125°



Kitchens

Doors

Kitchen Accessories

Hinges



Full Overlay

Description

- 3-dimensional adjustment with suitable base plate
- Soft-close compatible
- Accommodates overlays up to 19mm (3/4")
- For door thickness up to 19 mm
- Alternative solution for wide angle application
- Self-close hinges available
- For face frame and frameless cabinets
- Combination drilling pattern for Nexis Impresso

Full overlay

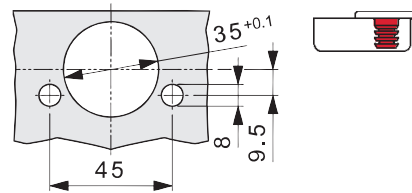
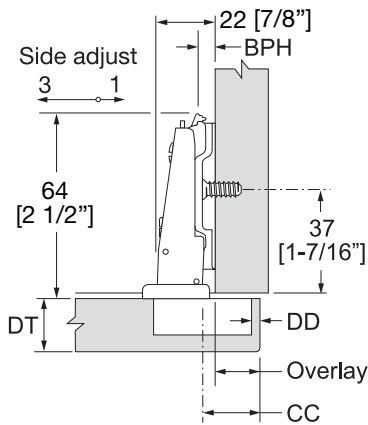
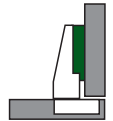

Drawings show mounting plate, thickness 02.

Cranking 00



Self-closing Screw-on..... **12-734**

Self-closing Dowels **12-748**

Half Overlay Screw-on **12-736**

Drawer Slides

Plywood Melamine

Veneer Edgebanding

Laminate

Solid Surface

Closets

Furniture Hardware

Pulls & Knobs

Lighting

Grommets

Locks, Lock Systems

Molding, Carvings

Tools

Adhesives Solvents Abrasives

Chemicals Staples Screws



Nexis Hinge 170°

Description

- 3-dimensional adjustment with suitable base plate
- Soft-close compatible
- Accommodates overlays up to 19mm (3/4")
- Shallow cup depth (11 mm) for Nexis and Nexis Impresso
- Zero protrusion when door opened 90°
- Finger protection
- Self-close or free-swing hinges available
- For face frame and frameless cabinets
- Combination drilling pattern for Nexis Impresso

Full overlay

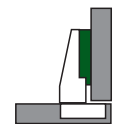

Full Overlay

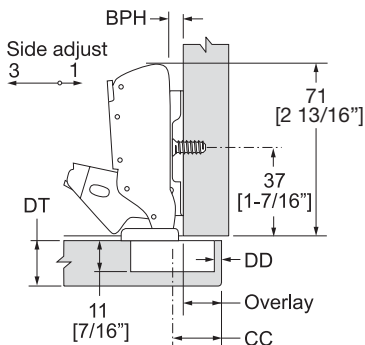

Drawings show mounting plate, thickness 02.

Cranking 00



Self-closing F/O Screw-on..... **12-784**

Self-closing F/O Dowels **12-749**

Free-swing F/O Screw-on **12-786**

Self-close Half/O Screw-on..... **12-788**

Benefits

- For door thicknesses of up to 26 mm. A trial application is recommended for doors thicker than 24 mm.
- Zero protrusion at a 90° door opening angle in 00 cranking and with 00 mounting plate thickness.

SNAP-ON HINGES



Nexis Hinge 95°-Thick Door

Description

- 3-dimensional adjustment with suitable base plate
- Soft-close compatible
- Accommodates overlays up to 19mm (3/4")
- Minimal gap dimensions on thick doors
- For door thickness up to 30 mm (1 3/16")
- Self-close or free-swing hinges available
- For face frame and frameless cabinets
- Combination drilling pattern for Nexis Impresso



Full overlay

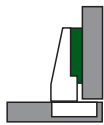

Half overlay

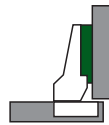

Inset

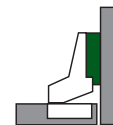

Cranking 00

Cranking 08

Cranking 15



Self-closing Screw-on..... **12-790**
Self-closing Dowels **12-804**

Self-closing Screw-on..... **12-794**

*Self-closing Screw-on .. **12-798***
FS Screw-on..... **12-802**

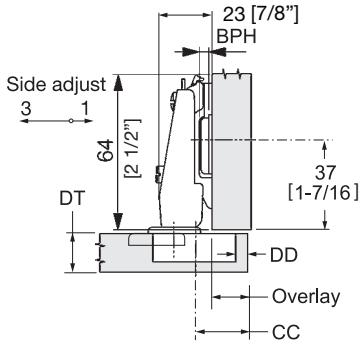

Drawings show mounting plate, thickness 02.

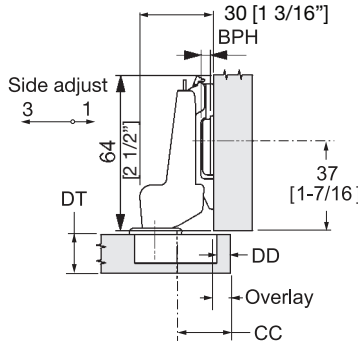

Drawings show mounting plate, thickness 02.

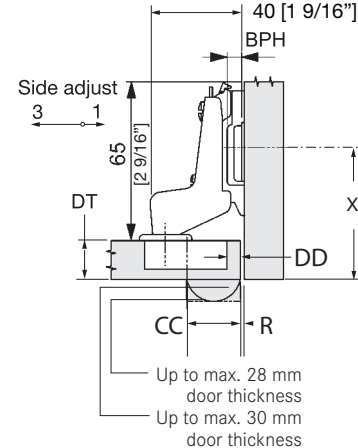

Drawings show mounting plate, thickness 04.

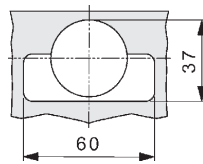
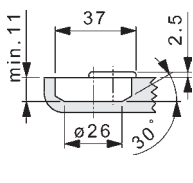
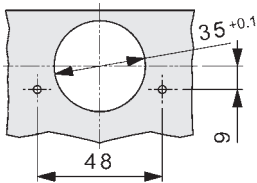

Adjustment

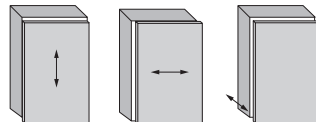

Height adjustment ± 2 mm
Side adjustment $+1/-3$ mm
Depth adjustment $+3/-1$ mm

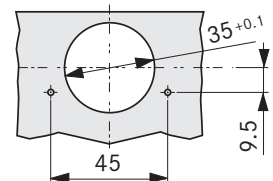

Item 12-798 Only

Kitchens

Doors

Kitchen Accessories

Hinges

Drawer Slides

Plywood Melamine

Veneer Edgbanding

Laminate

Solid Surface

Closets

Furniture Hardware

Pulls & Knobs

Lighting

Grommets

Locks, Lock Systems

Molding, Carvings

Tools

Adhesives Solvents Abrasives

Chemicals Staples Screws

SNAP-ON HINGES

Nexis Hinge 95° With 40mm Cup for Profile Doors

Kitchens

Doors

Kitchen Accessories

Hinges

Drawer Slides

Plywood Melamine

Veneer Edgbanding

Laminate

Solid Surface

Closets

Furniture Hardware

Pulls & Knobs

Lighting

Grommets

Locks, Lock Systems

Molding, Carvings

Tools

Adhesives Solvents Abrasives

Chemicals Staples Screws

Description

- 3-dimensional adjustment with suitable base plate
- Accommodates door overlays up to 23mm (7/8")
- Minimal gap dimensions on thick doors
- Excellent weight capacity for heavy profile doors
- For profile or frame doors up to 36 mm thick
- Special spring mechanism ensures excellent closing force - even with large doors
- Self-close hinges available
- For face frame and frameless cabinets



Full overlay

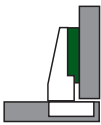

Half overlay

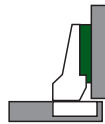

Inset



Cranking 00

Cranking 08

Cranking 15



Self-closing Screw-on..... 12-750

Self-closing Screw-on..... 12-752

Self-closing Screw-on..... 12-754

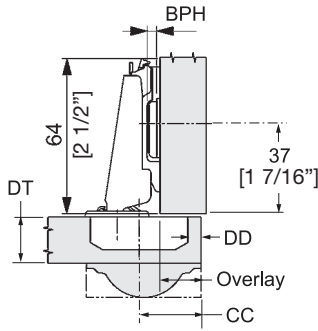

Drawings show mounting plate, thickness 02.

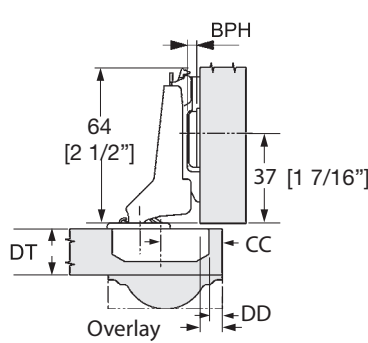

Drawings show mounting plate, thickness 02.

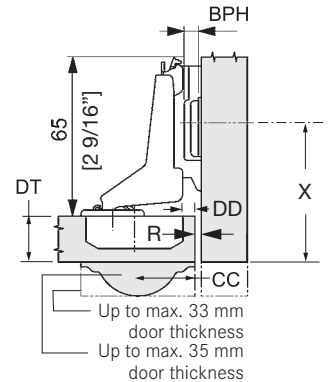

Drawings show mounting plate, thickness 04.

Adjustment

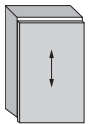

Height adjustment
±2 mm

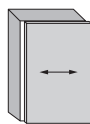

Side adjustment
+1/-3 mm

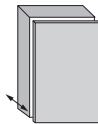

Depth adjustment
+3/-1 mm

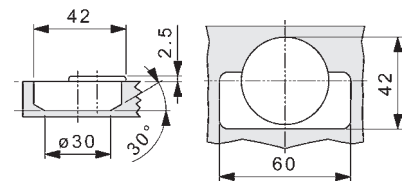
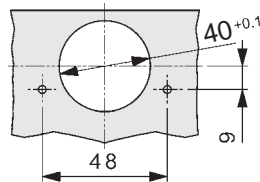

Most of the merchandise in this catalog is available in all Hardware Imagination-Tech locations. If your selection isn't available at the store nearest you, we'll gladly order it from one of the other stores or through special order.

G*GRASS

SNAP-ON HINGES

Nexis Hinge 95°/45° Angle Corner



Description

- 3-dimensional adjustment with suitable base plate
- Soft-close compatible
- Minimal gap dimensions on door thickness of up to 30 mm
- Self-close hinges available

Benefits

- For 45° corner cabinets and applications with a positive angle.
- Excellent minimum gap requirements with door thicknesses up to 30 mm
- Well suited for variable cabinet sides

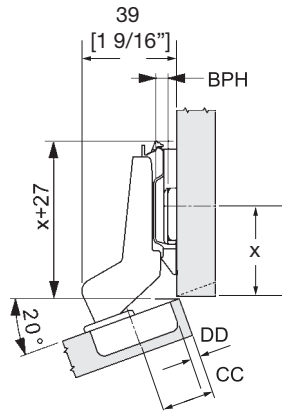

Nexis Self-closing Screw-on12-762
Nexis Impresso Self-closing12-765



Drawings show mounting plate, thickness 04.

Kitchens

Doors

Kitchen Accessories

Hinges

Drawer Slides

Plywood Melamine

Veneer Edgebanding

Laminate

Solid Surface

Closets

Furniture Hardware

Pulls & Knobs

Lighting

Grommets

Locks, Lock Systems

Molding, Carvings

Tools

Adhesives Solvents Abrasives

Chemicals Staples Screws



Nexis / Impresso 95° Blind Corner

Description

- 3-dimensional adjustment with suitable base plate
- Soft-close compatible
- Minimal gap dimensions on door thickness of up to 30 mm
- Self-close hinges available
- For blind corner cabinets

Benefits

- Used in special blind corner cabinet applications
- Excellent minimum gap requirements with thick doors
- Fully compatible with all standard mounting plates

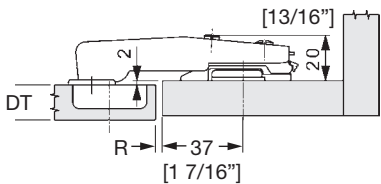

Drawings show mounting plate, thickness 02.

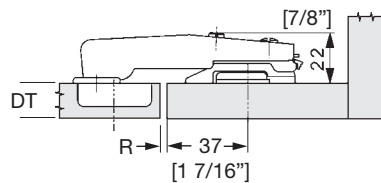

Drawings show mounting plate, thickness 04.

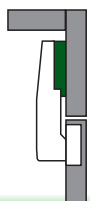
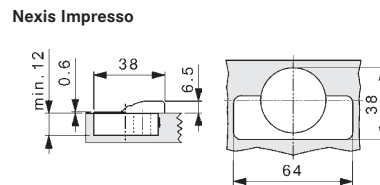
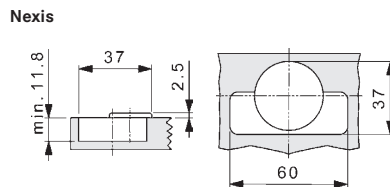

Inset - Nexis

Self-closing Screw-on..... 12-774
Self-closing Dowel 12-767



Inset - Impresso

Soft-closing Screw-on 12-770

SNAP-ON HINGES

Nexis Impresso – 110°



Kitchens

Doors

Kitchen Accessories

Hinges



Nexis Impresso

Description

- 3-dimensional adjustment with suitable base plate
- Soft-close compatible
- Shallow cup depth
- Nexis Impresso 11.5 mm
- Accommodates overlays up to 20mm (25/32")
- Self-close or free-swing hinges available
- For face frame and frameless cabinets
- Combination drilling pattern for Nexis Impresso

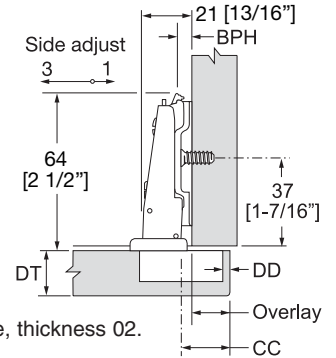

Drawings show mounting plate, thickness 02.

Cranking 00

Cranking 08

Full overlay

Half overlay

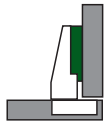

Self-closing 12-850

Self-closing 12-854

Nexis Impresso - 125° Angle



Furniture Hardware

Pulls & Knobs

Lighting



Nexis Impresso

Full Overlay

Description

- 3-dimensional adjustment with suitable base plate
- Soft-close compatible
- Accommodates overlays up to 19mm (3/4")
- For door thickness up to 19 mm
- Alternative solution for wide angle application
- Self-close hinges available
- For face frame and frameless cabinets
- Combination drilling pattern for Nexis Impresso

Full overlay

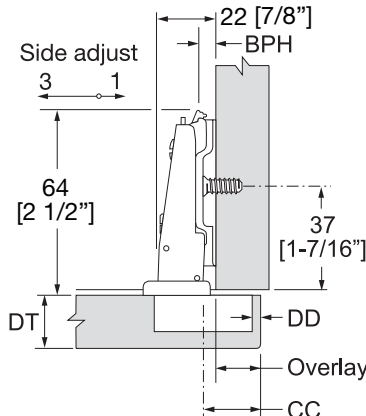
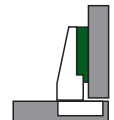

Nexis Impresso

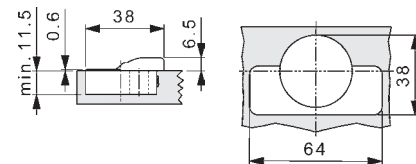

Drawings show mounting plate, thickness 02.

Cranking 00



Self-closing 12-840

SNAP-ON HINGES

G* GRASS

Impresso – 170° Angle



Nexis Impresso

Full Overlay

Description

- 3-dimensional adjustment with suitable base plate
- Soft-close compatible
- Accommodates overlays up to 19mm (3/4")
- Shallow cup depth (11 mm) for Nexis and Nexis Impresso
- Zero protrusion when door opened 90°
- Finger protection
- Self-close or free-swing hinges available
- For face frame and frameless cabinets
- Combination drilling pattern for Nexis Impresso

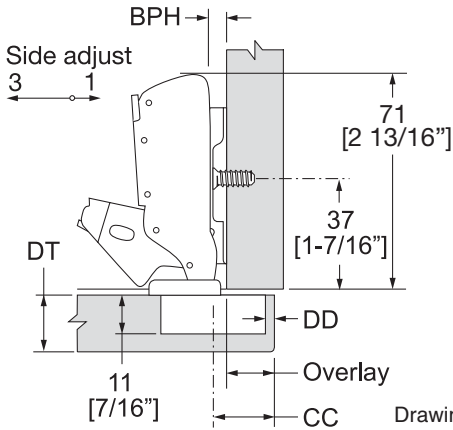

Drawings show mounting plate, thickness 02.

A trial application is recommended for doors thicker than 24 mm.

G* GRASS

Full overlay



Cranking 00



Self-closing 12-870

Nexis Impresso 95° - Thick Door

Full Overlay

Inset

Cranking 00 Cranking 15



Self-closing 12-842



Self-closing 12-844



Nexis Impresso

G* GRASS

Benefits

- Optimal gap requirements with door thicknesses of up to 30 mm
- Designed for thick and profile doors
- Ideal for pocket and flap doors

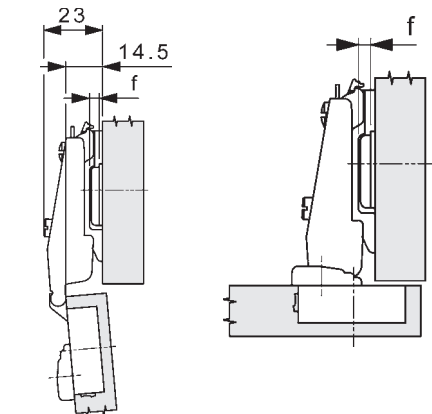

Drawings show mounting plate, thickness 02.

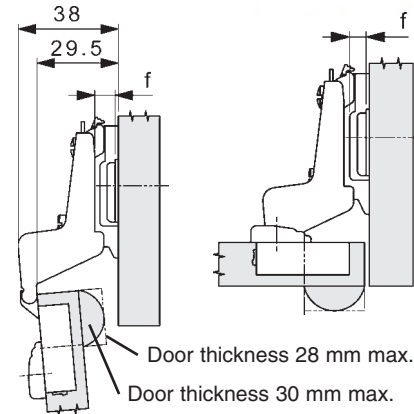

Drawings show mounting plate, thickness 04.

Kitchens

Doors

Kitchen Accessories

Hinges

Drawer Slides

Plywood Melamine

Veneer Edgbanding

Laminate

Solid Surface

Closets

Furniture Hardware

Pulls & Knobs

Lighting

Grommets

Locks, Lock Systems

Molding, Carvings

Tools

Adhesives Solvents Abrasives

Chemicals Staples Screws

SNAP-ON HINGES

Nexis PCC Pie Cut Corner

Kitchens

Doors

Kitchen Accessories

Hinges

Drawer Slides

Plywood Melamine

Veneer Edgebanding

Laminate

Solid Surface

Closets

Furniture Hardware

Pulls & Knobs

Lighting

Grommets

Locks, Lock Systems

Molding, Carvings

Tools

Adhesives Solvents Abrasives

Chemicals Staples Screws



Description

- 3-dimensional adjustment with suitable base plate
- Designed for folding doors in corner cabinets
- For door thicknesses Max. 24 mm, factory setting 19 mm door thickness with 3.5 mm drilling distance
- Self-close hinges available
- Used in conjunction with Nexis 170 hinges
- Shallow cup depth of 10.8 mm

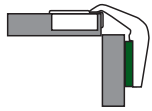

Adjustment In The Hinge Arm

1. Side Adjustment ± 2 mm
2. Depth Adjustment ± 2 mm
4. Door Thickness 14 To 24 mm, Factory Setting 19 mm

Adjustment Via Base Plate

3. Height Adjustment ± 2 mm

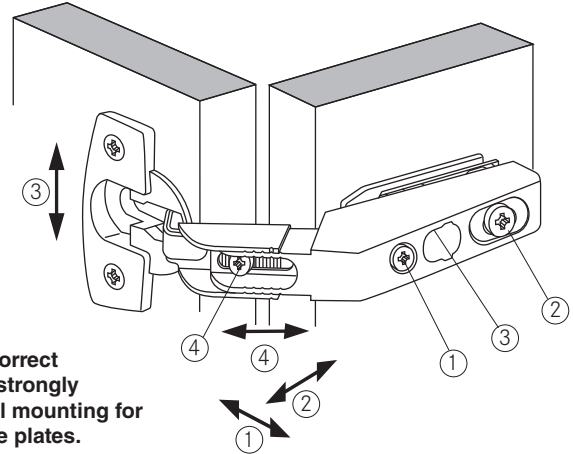

Self-closing Screw-on..... 12-776

IMPORTANT
To determine the correct application Grass strongly recommends a trial mounting for all hinges and base plates.

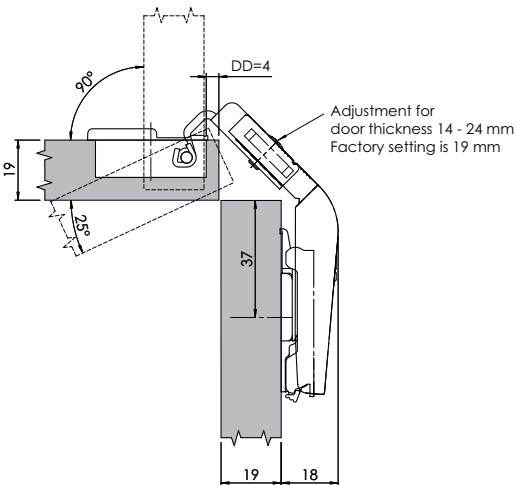

DD = Drilling distance
Drawings with base plate, height 00 for door thickness 19mm, factory setting.
Drilling distance range 3 mm - 6 mm

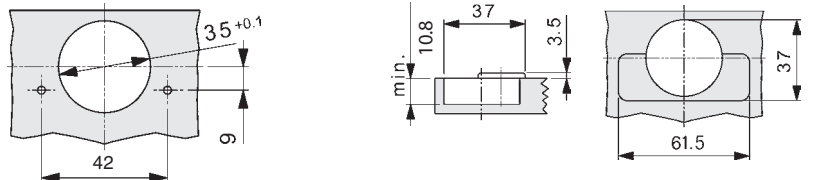
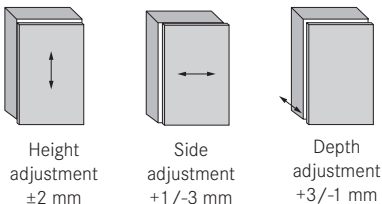
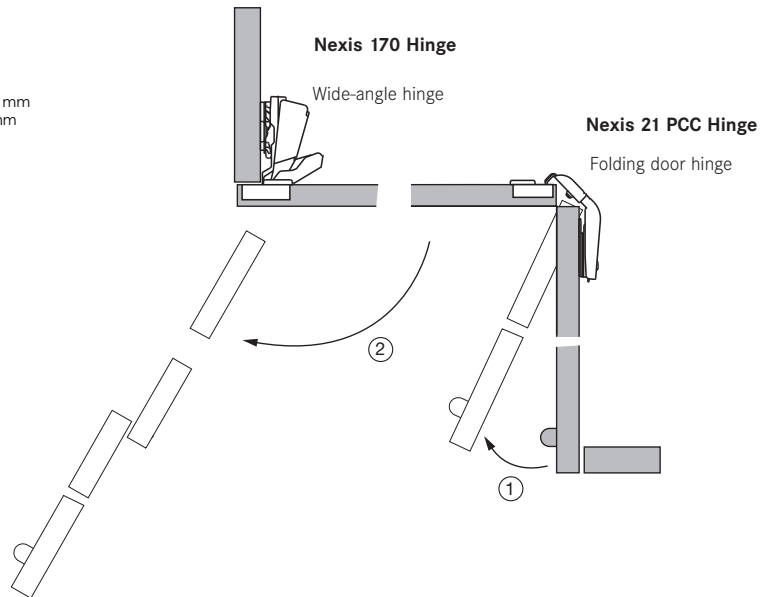

SELF / SOFT CLOSE HINGES

Soft-Close Nexis - Unique Door Hinge System

Soft-close Nexis – quick and easy to install.

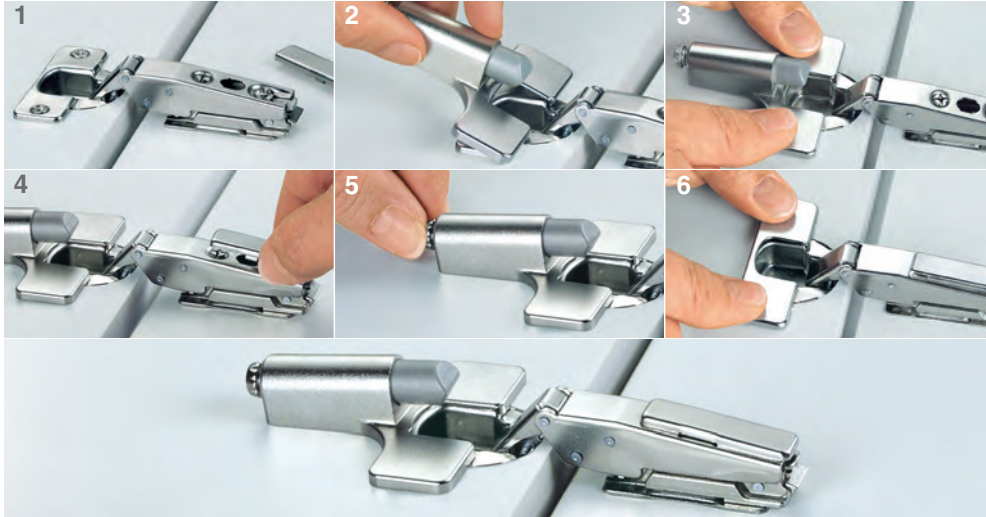

Please Check:
Are notches located on both sides of the hinge cup?

The optional Soft-close Nexis is suitable for the following hinges of the new Nexis Click-on series: Nexis 04, Nexis 05, Nexis 22 and Nexis 29.

Cover cap for Nexis hinge cup



Order Number **12-882**

Soft-close Nexis adapter

With pre-mounted Soft-close



Order Number **12-880**

Soft-Close for Impresso

1 Set consisting of:

- 1 Soft-close CST adapter
- 2 Hinge arm cover caps

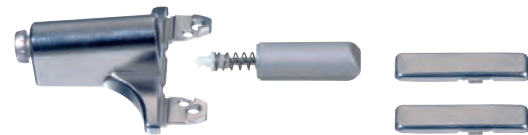
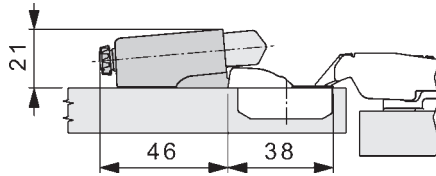

Order Number **12-884**

Suitable for new Impresso 04, Impresso 05, Impresso 22 and Impresso 29 hinges

Soft-Close

Description

- Works for face frame cabinets on all door overlays
- Works for frameless cabinets on full overlay doors
- Blends in well with hinge finish
- Non-handed with a low profile design
- Manually adjustable to desired closing speed
- Easy to mount by locating in the corner
- Scratch protector and front bumper with cushion for a quiet close

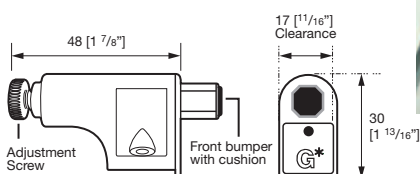

Order Number **12-888**

Kitchens

Doors

Kitchen Accessories

Hinges

Drawer Slides

Plywood Melamine

Veneer Edgebanding

Laminate

Solid Surface

Closets

Furniture Hardware

Pulls & Knobs

Lighting

Grommets

Locks, Lock Systems

Molding, Carvings

Tools

Adhesives Solvents Abrasives

Chemicals Staples Screws

SNAP-ON HINGES

Nexis Mounting Plates



Kitchens

Fixing distance 37 mm, line boring 32 mm

Doors

Kitchen Accessories

Hinges

Drawer Slides

Plywood Melamine

Veneer Edgebanding

Laminate

Solid Surface

Closets

Furniture Hardware

Pulls & Knobs

Lighting

Grommets

Locks, Lock Systems

Molding, Carvings

Tools

Adhesives Solvents Abrasives

Chemicals Staples Screws

DESCRIPTION

PLATE THICKNESS

ORDER NO.

PHOTO

Steel plate for wood screw fixing, fixing distance 37 mm, line boring 32 mm

Height adjustment: ± 2 mm
Side adjustment: $+1/-3$ mm
Depth adjustment: $+3/-1$ mm
All adjustment options are independent of one another.

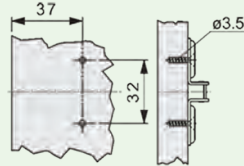

00

12-900

02

12-902

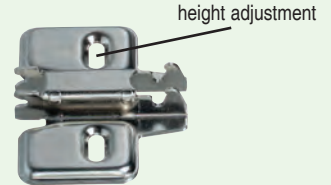

Steel plate with pre-mounted Euro-screws, fixing distance 37 mm, line boring 32 mm

Height adjustment: ± 2 mm
Side adjustment: $+1/-3$ mm
Depth adjustment: $+3/-1$ mm
All adjustment options are independent of one another.

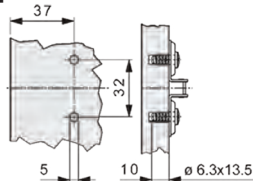

00

12-904

02

12-906

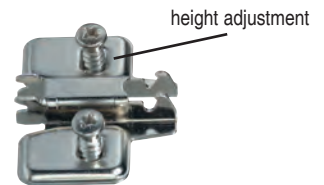

Cam plate for wood screw fixing, with three point mounting.

00

12-932

02

12-934

04

12-937

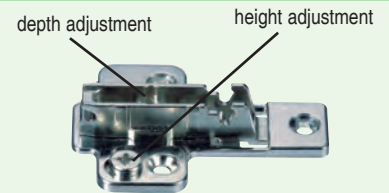

Cam plate with pre-mounted Euro-screws with three point mounting

00

12-944

02

12-946

04

12-941

08

12-939 **

** With Euro Screws

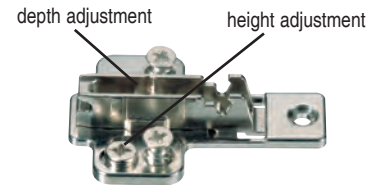

Height adjustment: ± 2 mm
Side adjustment: $+1/-3$ mm
Depth adjustment: $+3/-1$ mm
All adjustment options are independent of one another.

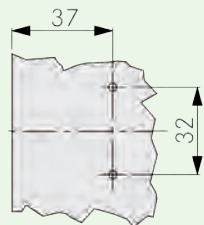

00

12-950

02

12-952

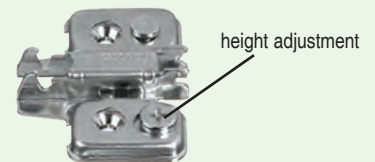

Height adjustment: ± 2 mm
Side adjustment: $+1/-3$ mm
Depth adjustment: $+3/-1$ mm
All adjustment options are independent of one another.

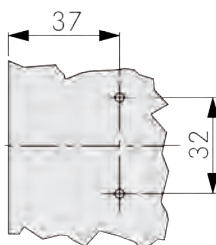

00

12-951

02

12-954

04

12-956

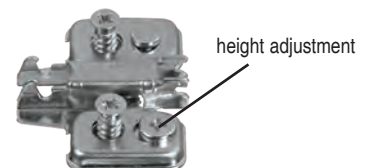

SNAP-ON HINGES



Nexis Mounting Plates

Fixing distance 37 mm, line boring 32 mm

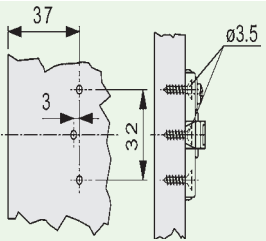
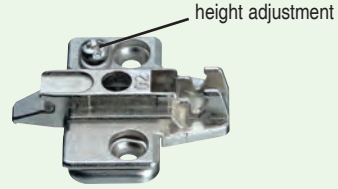
DESCRIPTION	PLATE THICKNESS	ORDER NO.	PHOTO
Zinc diecast plate for wood screw fixing, fixing distance 37 mm, line boring 32 mm 	00	12-910	
	02	12-926	
	04	12-928	
	08	12-912	
	18	12-914	

Tiomos Mounting Plates

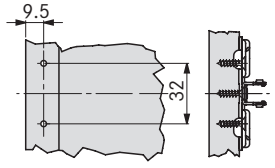
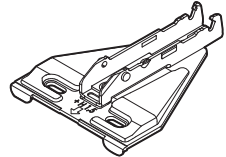
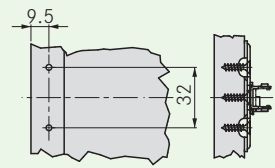
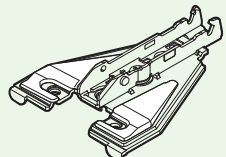
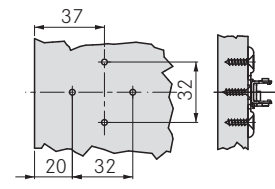
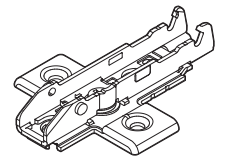
<ul style="list-style-type: none"> • Steel, nickel plated • Depth adjustment via worm gear • Height adjustment via <u>elongated hole</u> • Side adjustment via hinge • Use a #2 Pozi drive for hinge Adj. • Attach baseplates using all available screw holes 	<table border="1"> <tr> <td>1.5</td> <td>*12-969</td> </tr> <tr> <td>3.5</td> <td>*12-968</td> </tr> </table>	1.5	*12-969	3.5	*12-968	
1.5	*12-969					
3.5	*12-968					
<ul style="list-style-type: none"> • Steel, nickel plated • Depth adjustment via worm gear • Height adjustment via <u>worm gear</u> • Side adjustment via hinge • Use a #2 Pozi drive for hinge Adj. • Attach baseplates using all available screw holes 	<table border="1"> <tr> <td>1.5</td> <td>*12-967</td> </tr> <tr> <td>3.5</td> <td>12-966</td> </tr> </table>	1.5	*12-967	3.5	12-966	
1.5	*12-967					
3.5	12-966					
<ul style="list-style-type: none"> • Steel, nickel plated • Depth adjustment via worm gear • Height adjustment via worm gear • Side adjustment via hinge • Use a #2 Pozi drive or hinge adj. • Attach baseplates using all available screw holes 	<table border="1"> <tr> <td>3.5</td> <td>12-972</td> </tr> </table>	3.5	12-972			
3.5	12-972					

Special mounting plates for face frame construction

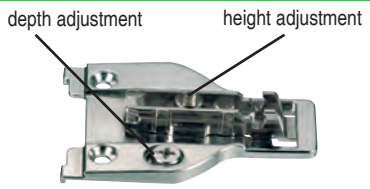
3-D cam plate for face frame construction, for wood screw fixing	<table border="1"> <tr> <td>5/8" OL</td> <td>12-940</td> </tr> <tr> <td>1/2" OL</td> <td>12-942</td> </tr> </table>	5/8" OL	12-940	1/2" OL	12-942	
5/8" OL	12-940					
1/2" OL	12-942					
Special plate for face frame construction, for wood screw fixing.	<table border="1"> <tr> <td>5/8" OL</td> <td>12-920</td> </tr> <tr> <td>1/2" OL</td> <td>12-922</td> </tr> </table>	5/8" OL	12-920	1/2" OL	12-922	
5/8" OL	12-920					
1/2" OL	12-922					

Item Stocked in Roanoke, VA Only ~ All other locations available through Special Order.

Kitchens

Doors

Kitchen Accessories

Hinges

Drawer Slides

Plywood Melamine

Veneer Edgebanding

Laminate

Solid Surface

Closets

Furniture Hardware

Pulls & Knobs

Lighting

Grommets

Locks, Lock Systems

Molding, Carvings

Tools

Adhesives Solvents Abrasives

Chemicals Staples Screws

FACE FRAME HINGES

TEC 864 with 3-D Adjustment



Description

- 3-D adjustment hinges
- Cup depth only 10.5 mm (7/16")
- For door thicknesses from 12.5 mm (1/2") to 19 mm (3/4")
- All metal construction
- Concealed double torsion spring
- 108° opening angle
- Available overlays: 1/2", 3/4", 1", 1-1/4", 1-3/8"
- Wrap around face frame mounting

45mm drilling pattern

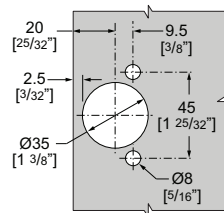

	TEC 864 1/2"	TEC 864 3/4"	TEC 864 1"
--	--------------	--------------	------------

Plywood Melamine			
Veneer Edgebanding			
Laminate	Screw-on 11-800 Dowels 11-806	Screw-on 11-812 Dowels 11-814	Screw-on 11-816 Dowels 11-818

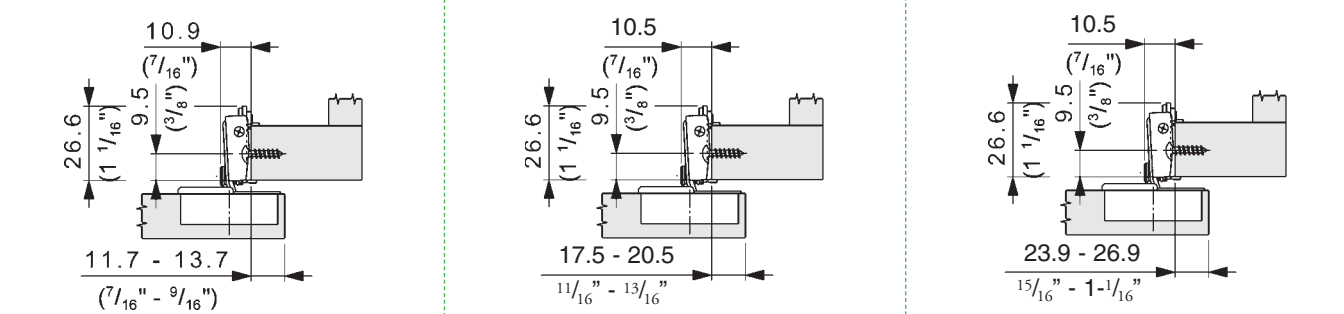

	TEC 864 1-1/4"	TEC 864 1-3/8"
--	----------------	----------------

Grommets	 10.5 (7/16") 25.7 (1") 9.5 (3/8") 32.2 - 35.2 (1 1/4" - 1 3/8")	 10.5 (7/16") 25.7 (1") 9.5 (3/8") 33.4 - 36.4 (1 5/16" - 1 7/16")
Locks, Lock Systems	Screw-on 11-802 Dowels 11-808	Screw-on 11-804 Dowels 11-810

ACC - 140



Description

- 130° Opening angle
- Suitable for overlays from 26-29 mm

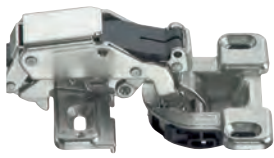

Screw-on **11-186**

Benefits

- Small gaps
- Best access into cabinet
- Sturdy and strong hinge design

- Kitchens
- Doors
- Kitchen Accessories
- Hinges
- Drawer Slides
- Plywood Melamine
- Veneer Edgebanding
- Laminate
- Solid Surface
- Closets
- Furniture Hardware
- Pulls & Knobs
- Lighting
- Grommets
- Locks, Lock Systems
- Molding, Carvings
- Tools
- Adhesives Solvents Abrasives
- Chemicals Staples Screws

Drilling and insertion machine for 45mm boring pattern

Description

- Bore depth automatically adjusts to material thickness
- Functional design
- Accurate fence is easily adjusted
- Chip removal by air on pneumatic machines
- Easy, fast and efficient operation
- Easy maintenance
- 45 mm boring pattern



Order Number **11-101**



Pneumatic control
Pneumatic feed and pneumatic hold-down device.



Hold-down block
Optimum fixing on the Ecopress
Pneumatic with the pneumatic hold-down device.

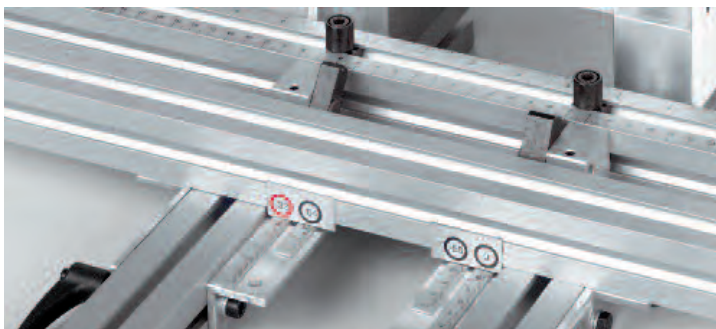

Scale bar
Graduated scale for exact measurement on the machine.

SPECIALTY HINGES

6-Way Adjustable Face Frame Hinge

Kitchens

Doors

Kitchen Accessories

Hinges

Drawer Slides

Plywood Melamine

Veneer Edgebanding

Laminate

Solid Surface

Closets

Furniture Hardware

Pulls & Knobs

Lighting

Grommets

Locks, Lock Systems

Molding, Carvings

Tools

Adhesives Solvents Abrasives

Chemicals Staples Screws

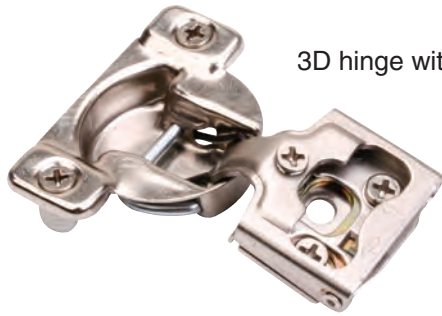

3D hinge with cam adjustment

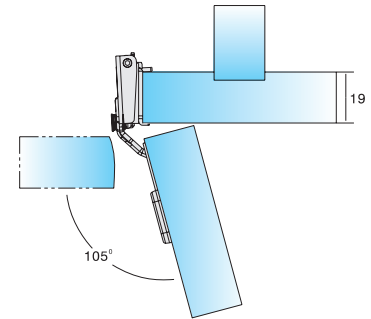
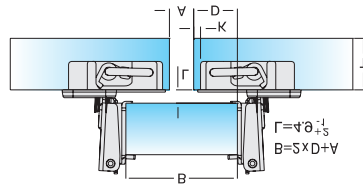

6 mm

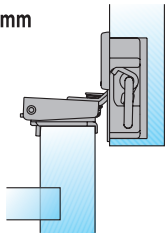

1/4" Overlay

screw-on w/dowel
14-114 14-116

31.4 mm

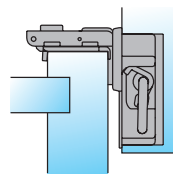

1 1/4" Overlay

screw-on w/dowel
14-150 14-152

13 mm

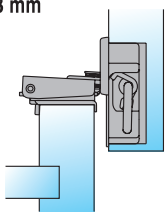

1/2" Overlay

screw-on w/dowel
14-112 14-110

34.9 mm

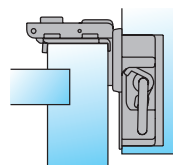

1 3/8" Overlay

screw-on w/dowel
14-158 14-160

16 mm

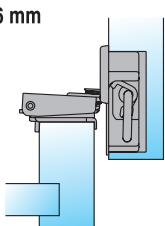

5/8" Overlay

screw-on w/dowel
14-117 14-118

38.4 mm

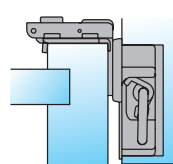

1 1/2" Overlay

screw-on w/dowel
14-162 14-164

19 mm

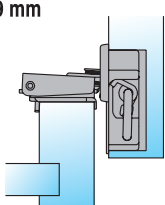

3/4" Overlay

screw-on w/dowel
14-154 14-156

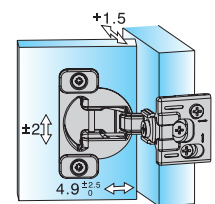
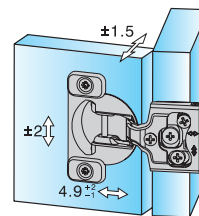

$\varnothing 35$ mm
Face Frame Hinge

Opening angle : 105°
Depth of hinge cup : 10.5 mm
Diameter of hinge cup : 35 mm
Drilling distance on the door(K) : 2.5 mm

Hinge cup types

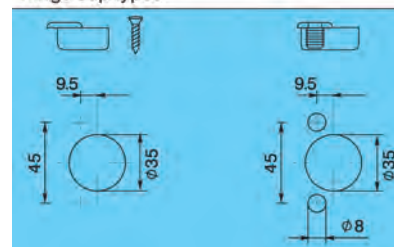

SPECIALTY HINGES



304B Stainless Steel Concealed Hinges

Description:

- Material: 304B Stainless Steel
- Finish: Polished
- 100° Opening
- Cup dia Ø 35 / Bore depth 11 mm
- Door thickness 15-20 mm

19 mm Overlay



- Self-closing Overlay **55-300**
- Free-swinging Overlay **55-304**

14 mm Overlay



- Self-closing Overlay **55-308**
- Free-swinging Overlay **55-310**

9 mm Overlay



- Self-closing Overlay **55-314**
- Free-swinging Overlay **55-316**

Mounting Plate



Mounting Plate..... **55-312**

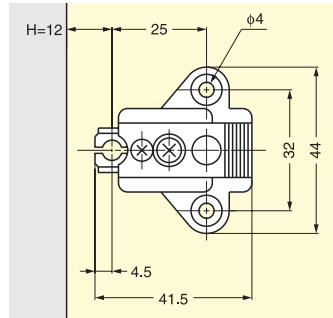

Fixed Pin Institutional Hinge

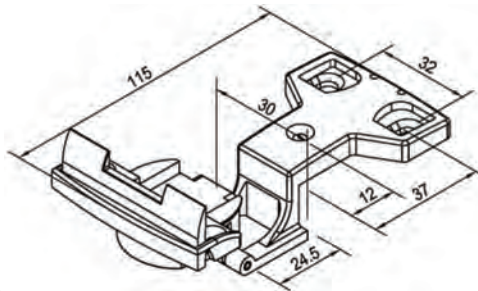

Sold Separately

Description

- 3-way adjustable
- Nickel plated
- Full overlay
- Self-closing
- Opening 270 degree

Order Number	Description
11-210	Screws
11-212	Hinge Cup
11-214	Hinge Arm



Kitchens

Doors

Kitchen Accessories

Hinges

Drawer Slides

Plywood Melamine

Veneer Edgbanding

Laminate

Solid Surface

Closets

Furniture Hardware

Pulls & Knobs

Lighting

Grommets

Locks, Lock Systems

Molding, Carvings

Tools

Adhesives Solvents Abrasives

Chemicals Staples Screws

SPECIALTY HINGES

Pivot Hinges

Kitchens

Doors

Kitchen Accessories

Hinges

Drawer Slides

Plywood Melamine

Veneer Edgebanding

Laminate

Solid Surface

Closets

Furniture Hardware

Pulls & Knobs

Lighting

Grommets

Locks, Lock Systems

Molding, Carvings

Tools

Adhesives Solvents Abrasives

Chemicals Staples Screws

- Screw-Mounted
- Max. Door Opening Angle 250°
- Without Stop
- With Outer Knuckle
- Fitted Above Doors
- Creates A Concealed Look
- Installed On Top Or Bottom Edge Of Door.
- Pivot Sets Are Equipped With A Heavy-Weight Anti-Friction Bearing Assembly.

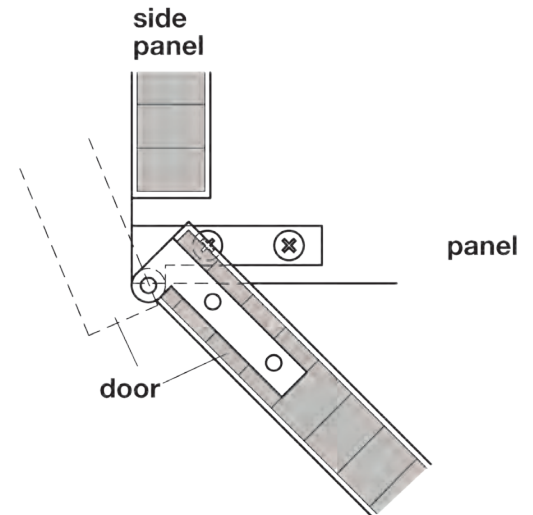
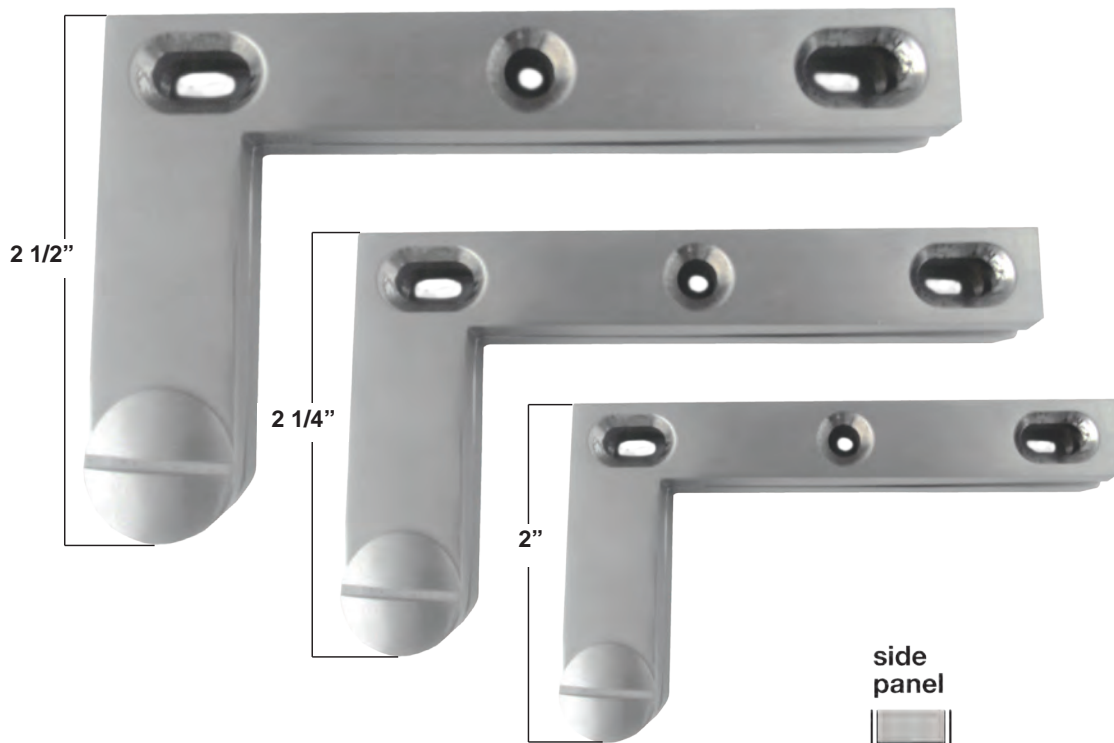

PART #	DESCRIPTION
55-184	2" PIVOT HINGE
55-186	2 1/4" PIVOT HINGE
55-188	2 1/2" PIVOT HINGE

SPECIALTY HINGES

Pivot Hinges

- Screw-Mounted
- Max. Door Opening Angle 250°
- Without Stop
- With Outer Knuckle
- Fitted Above Doors
- Creates A Concealed Look
- Installed On Top Or Bottom Edge Of Door.
- Pivot Sets Are Equipped With A Heavy-Weight Anti-Friction Bearing Assembly.

Kitchens

Doors

Kitchen Accessories

Hinges

Drawer Slides

Plywood Melamine

Veneer Edgebanding

Laminate

Solid Surface

Closets

Furniture Hardware

Pulls & Knobs

Lighting

Grommets

Locks, Lock Systems

Molding, Carvings

Tools

Adhesives Solvents Abrasives

Chemicals Staples Screws

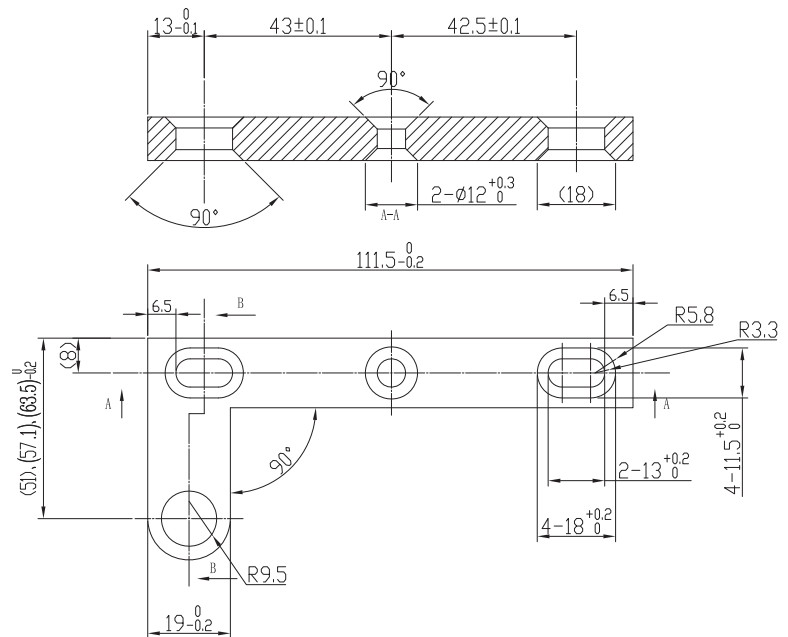
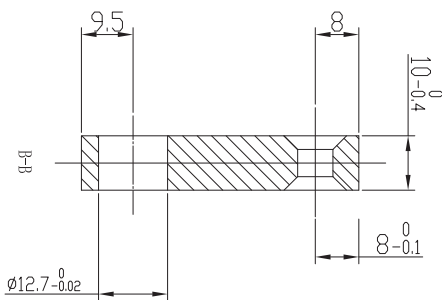

SPECIALTY HINGES

Glass Door Hinges & Catch Plates

Kitchens

Non-bore "TECH" Glass Door Hinge

Doors

Kitchen Accessories

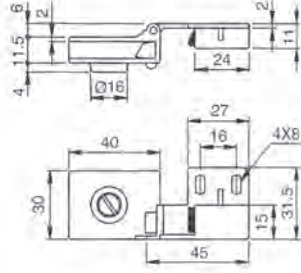
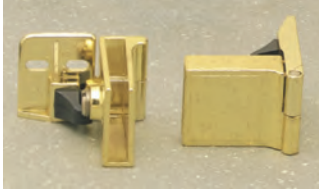

- Removable Lock Catch
- Fits 3/16" or 1/4" Glass
- Opening Angle 170°
- Height Adjustable
- Easy Installation
- Economical

Inset Brass 13-270
Inset Chrome 13-272
Overlay Brass 13-274
Overlay Chrome..... 13-276

Hinges

Drawer Slides

Plywood Melamine

Veneer Edgebanding

Non-bore Glass Door Simplex Inlay Hinge

Laminate

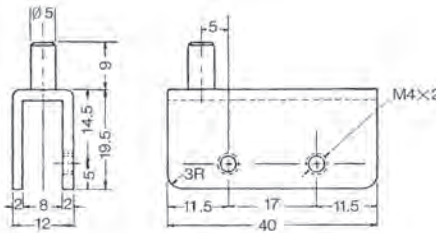

- Fits 3/16" or 1/4" Glass
- Application: Inset door
- Sold per Pair

Polished Brass 13-108
Polished Chrome... 13-106

Closets

Furniture Hardware

Non-bore Catch Plates

Slip-on Plate

Lighting

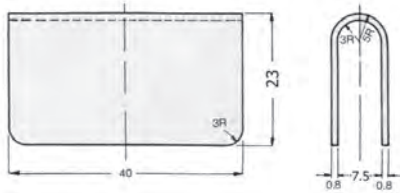
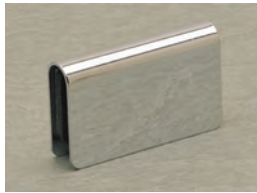

- Fits 3/16" or 1/4" Glass
- Adhesive cushion included
- Use with magnetic touch latch
- Sold per piece

Polished Brass 13-178
Polished Chrome... 13-180

Grommets

Locks, Lock Systems

Molding, Carvings

Slip-on Plate with Pull

Tools

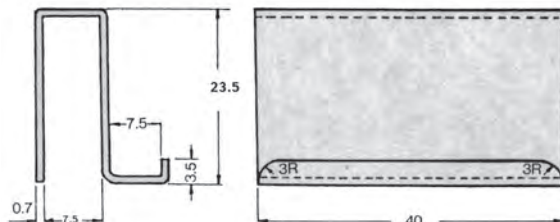
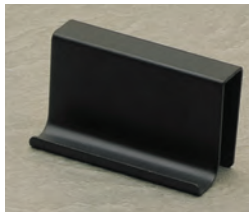

- Fits 3/16" or 1/4" Glass
- Adhesive cushion included
- Use with magnetic touch latch
- Sold per piece

Polished Brass 13-110
Polished Chrome... 13-112

Adhesives Solvents Abrasives

Chemicals Staples Screws

SPECIALTY HINGES

Suitable for flaps of max. 20 mm (3/4") thickness

Flap Hinge

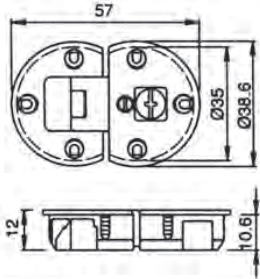

- Three-way adjustable
- Angle of opening: 90°
- Diameter of both parts: 35 mm
- Depth of both parts: 12 mm

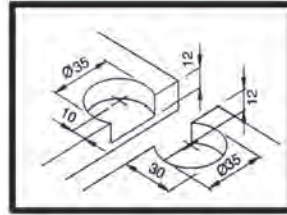

Nickel Plated 15-134

Kitchens

Doors

Kitchen Accessories

Hinges

Drawer Slides

Plywood Melamine

Veneer Edgbanding

Laminate

Solid Surface

Closets

Furniture Hardware

Pulls & Knobs

Lighting

Grommets

Locks, Lock Systems

Molding, Carvings

Tools

Adhesives Solvents Abrasives

Chemicals Staples Screws

All hinges sold with screws

Cabinet Hinges

Slab Hinges

- Decorite Chrome 21-146
- Decorite Antique Brass..... 21-300
- Decorite White Epoxy 21-302
- Decorite Polished Brass..... 21-304
- Decorite Satin Chrome..... 21-306

3/8" Offset Hinges

- Chrome 21-132
(not shown)



Slotted Pin Hinge for Overlay Door

- Bright Nickel Youngsdale (Y5)..... 21-158
- Antique Brass Youngsdale (Y5)..... 21-262
- Bright Nickel Youngsdale (Y6)..... 21-228

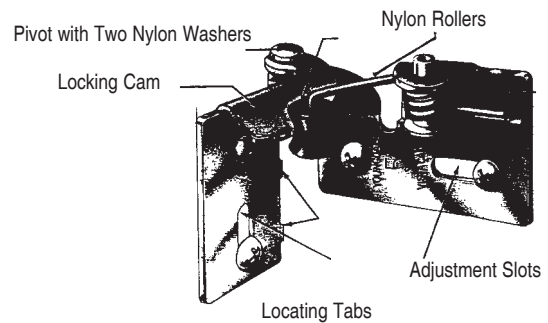

RPC Institutional Hinge

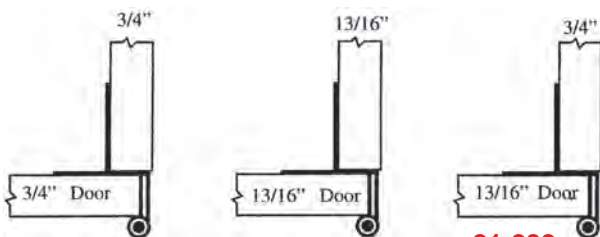

- 2-3/4" Five knuckle hinge .095 steel
- Designed for 32 mm hole system
- Hospital tips available
- Minartec tips only for 21-238
- Sold: each



21-238
Chrome

21-240
Chrome

21-232
Chrome
21-234
Black

SPECIALTY HINGES

Miscellaneous Hinges

Kitchens

Doors

Kitchen Accessories

Hinges

Drawer Slides

Plywood Melamine

Veneer Edgebanding

Laminate

Solid Surface

Closets

Furniture Hardware

Pulls & Knobs

Lighting

Grommets

Locks, Lock Systems

Molding, Carvings

Tools

Adhesives Solvents Abrasives

Chemicals Staples Screws

Piano Hinges

ORDER NO.	OPEN WIDTH	SCREWS INCLUDED	FINISH	MATERIAL	GAUGE
21-102	1-1/4"	NO	NICKEL	STEEL	.028
21-104	1-1/2"	NO	NICKEL	STEEL	.032
21-106	2"	NO	NICKEL	STEEL	.045
21-108	1-1/4"	NO	BRASS	STEEL	.028
21-110	1-1/2"	NO	BRASS	STEEL	.032
21-112	2"	NO	BRASS	STEEL	.045
21-126	1-1/16"	YES	BRITE STL	STNLS	.042
21-128	1-1/2"	YES	BRITE STL	STNLS	.042
21-130	2"	YES	BRITE STL	STNLS	.042

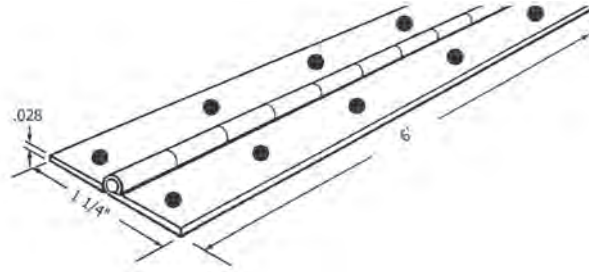

All lengths stocked 72" long with 2" hole centers

4" 2-Way Swing Hinge

Double action spring hinges give closing action from either direction. Energy is stored in the spring as the door is opened, and closes the door after it is released. Spring tension is adjustable at any time.

Sprayed Brass 21-182
Zinc Plated 21-184

Door thickness
3/4" to 1-1/4"

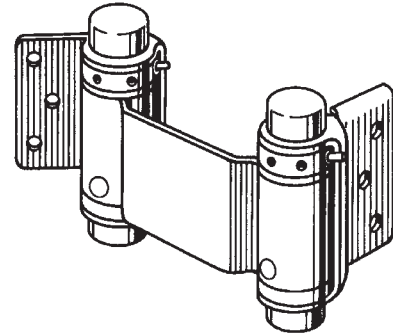
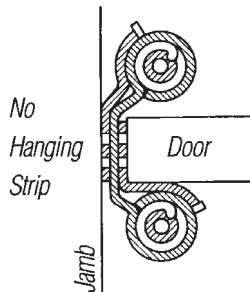

Heavy Duty Table Flap Hinge

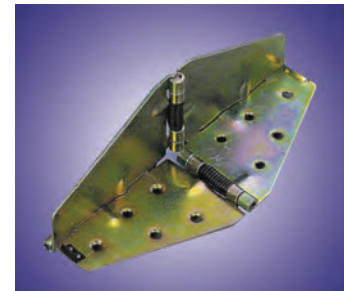
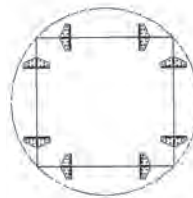
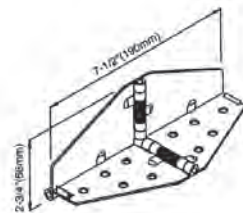
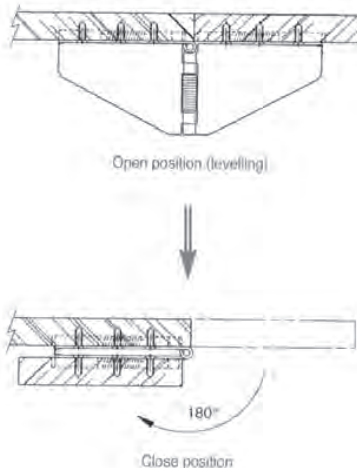

Order number 43-730

- Convert square tables to round or add length to any table
- .098 Gauge
- Sold individually with screws
- Yellow Zinc finish

SPECIALTY HINGES

Miscellaneous Hinges

Kitchens

-----SOSS® Invisible Hinges-----

BRASS PLATED INVISIBLE HINGE

ORDER NO.	MIN. WOOD THICKNESS	PLATE WIDTH	PLATE LENGTH
21-170	3/4"	1/2"	2-3/8"
21-171	1"	5/8"	2-3/4"
21-172	1-1/8"	3/4"	3-3/4"
21-174	1-3/4"	1-1/8"	4-5/8"
21-176	1-3/8"	1"	4-5/8"
21-178	2"	1-3/8"	5-1/2"



SATIN CHROME INVISIBLE HINGE

ORDER NO.	MIN. WOOD THICKNESS	PLATE WIDTH	PLATE LENGTH
21-168	3/4"	1/2"	2-3/8"
21-175	1-3/4"	1-1/8"	4-5/8"
21-177	1-3/8"	1"	4-5/8"



-----Adjustable Swing-out Fitting-----

The swing-up fitting works both as a hinge and a flap stay. Two adjustable springs keep the door open or closed.

- Ideal for overhead storage cabinet
- 75° Opening
- 1 Pair = 1 right and 1 left spring fitting
- Material: steel

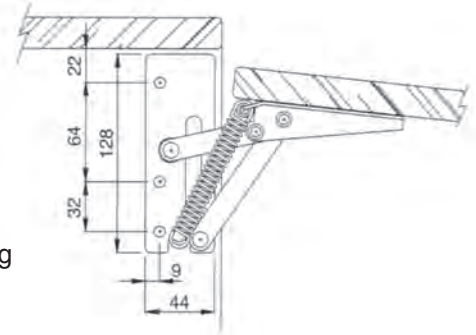

1 Pair - White 15-170



Solid Surface

Closets

Furniture Hardware

Pulls & Knobs

Lighting

Lift-up Hinge

By simply regulating the position of the two mounting plates the flap opening can be adjusted from 75° to 105° or more

Order number
15-180



Description

- High strength and LOAD capacity
- Precision mechanism to ensure light and smooth action
- Smooth opening – Flap held at any angle
- Can be mounted also on aluminium frame flap doors
- Totally unaffected by moisture

1



2



1. Screw on the quick mounting plates to cabinet and flap
2. Click on flap joint stay to mounting plates
3. Adjust friction force according to flap dimension and weight

3



Most of the merchandise in this catalog is available in all Hardware Imagination-Tech locations. If your selection isn't available at the store nearest you, we'll gladly order it from one of the other stores or through special order.



Lid Stays

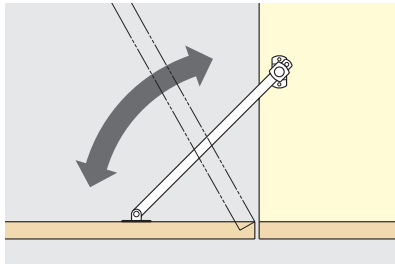

Order number **55-172**



- Material: 304 Stainless Steel
Polyamide
- Finish: Satin
- Left or right hand installation
- Screws not included

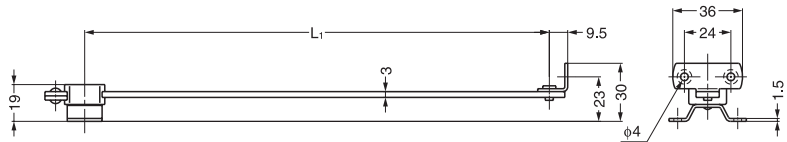
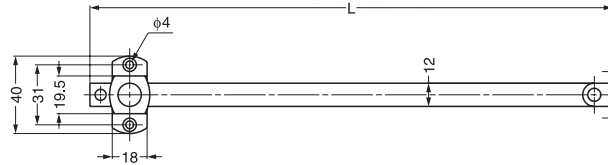

Order number **55-172**

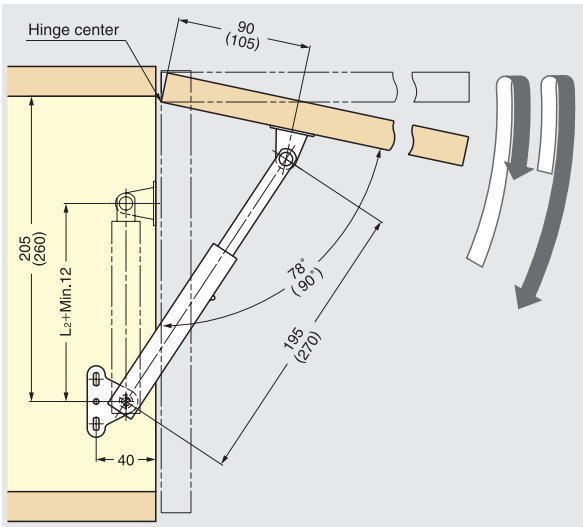

Order number **55-174**



Order number **55-176**

- Positive stop to keep flap open
- Left or right hand installation
- Material: 304 Stainless Steel
- Finish: Satin
- LOAD capacity: 15kg/ea (33 lbs.)
- Screws not included

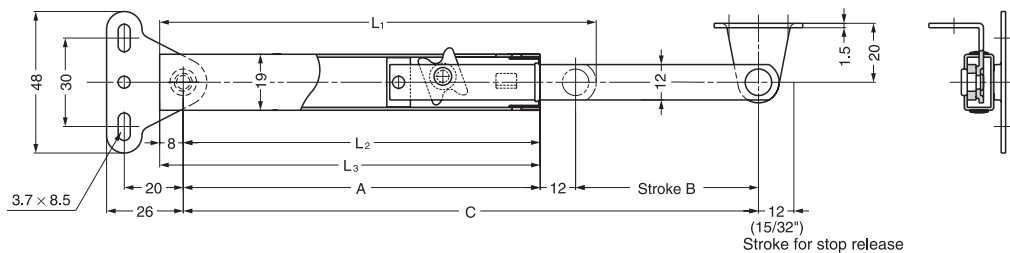
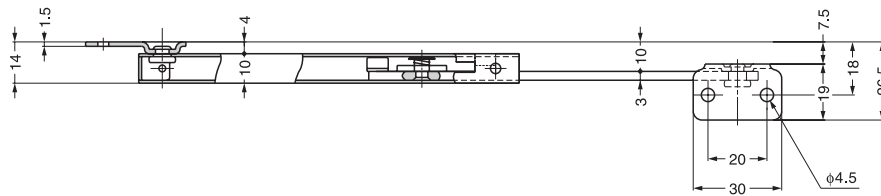

LID STAYS

Easy Lift-Up Stay

Kitchens

Doors

Kitchen Accessories

Hinges

Drawer Slides

Plywood Melamine

Veneer Edgebanding

Laminate

Solid Surface

Closets

Furniture Hardware

Pulls & Knobs

Lighting

Grommets

Locks, Lock Systems

Molding, Carvings

Tools

Adhesives Solvents Abrasives

Chemicals Staples Screws

SLS-ELAN



3 functions on 1 stay

1. Lift-assist

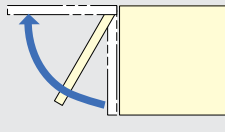

2. Free stop

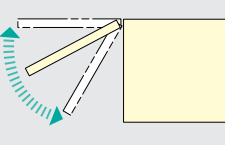

3. Soft-close

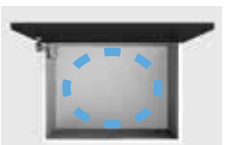
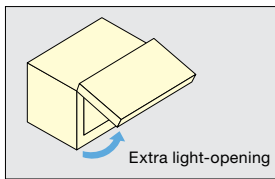
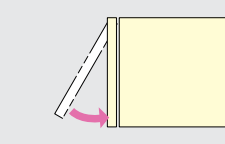

EASY LIFT-UP STAY

- Lift-assist mechanism for extra light-opening with free stop feature.
- Offers smooth and soft downward movement preventing lids or doors from slamming shut.
- Easy to install by aligning the body to the edge of cabinet.
- Recognized by LGA for 40,000 cycles.

Designed to operate at room temperature 0°~40°C (32°~104°F).

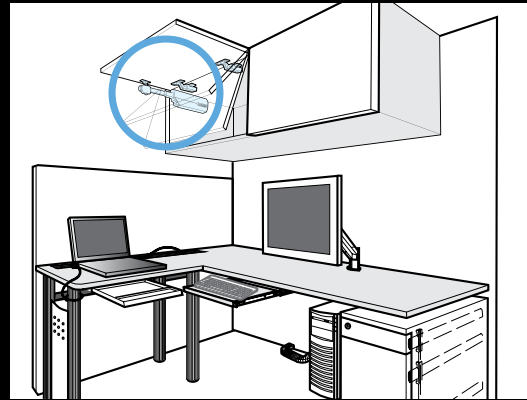
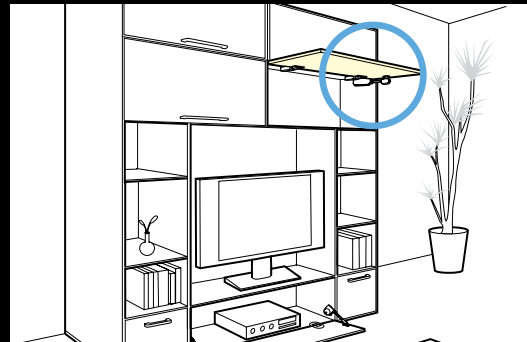

Arm Mounting Plate for Aluminum Frame Door

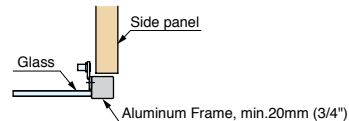
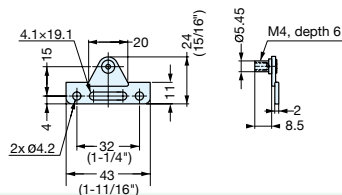

Easy Lift-Up Stay

EASY LIFT-UP STAY



- For UPWARD-OPENING FLAP DOOR with concealed, piano, butt, or drop hinges.
- Designed to provide effortless opening and hold door in closed and opened position.
- Damper equipped for soft & silent closing.
- Optional bracket for aluminum frame door available.
- Single or pair use allows wide range of door sizes/weights.
- Handed left or right.

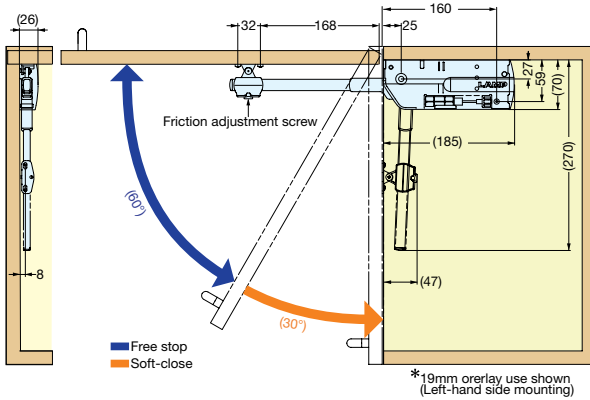

Easy Installation

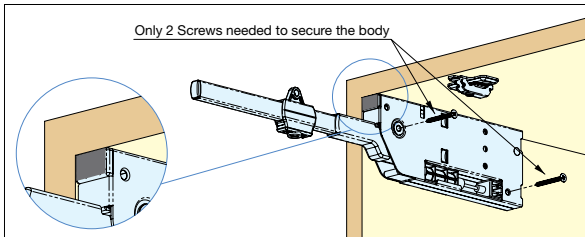

Adjustment

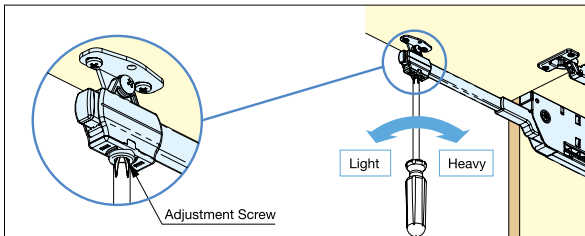

Door Weight Range Table (lbs.)

Door Height (inch)	Single use				Pair use			
	M-type		H-type		M-type		H-type	
	Min	Max	Min	Max	Min	Max	Min	Max
12"	8.0	10.8	10.8	14.5	16.0	21.7	21.7	29.0
13"	7.4	10.0	10.0	13.4	14.8	20.0	20.0	26.8
14"	6.9	9.3	9.3	12.4	13.7	18.6	18.6	24.9
15"	6.4	8.7	8.7	11.6	12.8	17.3	17.3	23.2
16"	6.0	8.1	8.1	10.9	12.0	16.3	16.3	21.8
17"	5.6	7.6	7.6	10.2	11.3	15.3	15.3	20.5
18"	5.3	7.2	7.2	9.7	10.7	14.4	14.4	19.3
19"	5.1	6.8	6.8	9.2	10.1	13.7	13.7	18.3
20"	4.8	6.5	6.5	8.7	9.6	13.0	13.0	17.4
21"	4.6	6.2	6.2	8.3	9.1	12.4	12.4	16.6
22"	4.4	5.9	5.9	7.9	8.7	11.8	11.8	15.8
23"	4.2	5.7	5.7	7.6	8.3	11.3	11.3	15.1
24"	4.0	5.4	5.4	7.3	8.0	10.8	10.8	14.5
25"	3.8	5.2	5.2	7.0	7.7	10.4	10.4	13.9
26"	3.7	5.0	5.0	6.7	7.4	10.0	10.0	13.4
27"	3.6	4.8	4.8	6.4	7.1	9.6	9.6	12.9
28"	3.4	4.6	4.6	6.2	6.9	9.3	9.3	12.4

*Single or pair use depending on door size and weight.

Order Number	Type	Torque Per Piece	Material	Finish / Color
15-176	Left	75~100 kg.cm (65-87 lbs.in)	• Aluminum • Steel • ABS	• Anodized • Galvanized • Light Grey
15-178	Right			

Kitchens

Doors

Kitchen Accessories

Hinges

Drawer Slides

Plywood Melamine

Veneer Edgebanding

Laminate

Solid Surface

Closets

Furniture Hardware

Pulls & Knobs

Lighting

Grommets

Locks, Lock Systems

Molding, Carvings

Tools

Adhesives Solvents Abrasives

Chemicals Staples Screws

LID STAYS

Kinvaro Lifter System

Kitchens

Doors

Kitchen Accessories

Hinges

Drawer Slides

Plywood Melamine

Veneer Edgebanding

Laminate

Solid Surface

Closets

Furniture Hardware

Pulls & Knobs

Lighting

Grommets

Locks, Lock Systems

Molding, Carvings

Tools

Adhesives Solvents Abrasives

Chemicals Staples Screws

Description

- The integral damping device slows down the door enabling a Soft-close® action
- The Lifter permits a zero top reveal through its multi-pivot points allowing cabinets to be stacked
- Maximum door opening angle of 100°
- A wide range of cabinet doors can be accommodated
- Door opens with a light touch and remains in place from 45° to its top position
- Lifter mounts towards the top which enables multiple shelves
- Door height adjustment via cam of +/- 2mm (1/8") through keyhole mounting screws

Order information:

1. Hardware components are supplied as a set to mount on wooden or aluminum framed doors with a minimum 45mm (1") stile width.
2. The following combination of factors determine what spring configuration to use: Cabinet height and width, door weight.
3. KB-65 Lifter Sets include: Right & Left Hand Lifter units with integral door mounting brackets and gray cover caps, one set of balance springs are pre-installed, one extra pair of coded springs are included for alternate weight ranges.



Door Type	Door Overlay	Order Number
Wood	14-9/16"	15-174

Step 1

Choose the Lifter Set:

- Lifter sets for wood doors also cover aluminum frame doors with a minimum stile width of 45mm (1 3/4")

Step 2

Choose the correct spring configuration:

- From the tables below, choose the door height in the first column
- Cross reference to the door weight including handle in the second column
- Check door width from the third or fourth column depending on which type of handle will be used
- The combination of this data determines the application and springs
- Lifter units come with black springs pre-installed.
Yellow springs must be installed for light and medium applications

Light Applications - Yellow spring mounted on one side

Door Height	Door Wt. lbs. [kg]	Door width small handle	Door width bar handle
250 [9 1/8"]	1.9 - 4.6 [0.9-2.1]	300 - 500 [11 1/8" - 19 1/8"]	300 - 350 [11 1/8" - 13 3/4"]
300 [11 1/8"]	1.5 - 3.7 [0.7-1.7]	300 - 350 [11 1/8" - 13 3/4"]	N/A

Medium Applications - Yellow springs mounted on both sides

Door Height	Door Wt. lbs. [kg]	Door width small handle	Door width bar handle
250 [9 1/8"]	4.0 - 9.2 [1.8-4.2]	450 - 1000 [17 1/8" - 39 3/8"]	350 - 750 [13 3/4" - 29 1/2"]
300 [11 1/8"]	3.1 - 7.5 [1.4-3.4]	300 - 700 [11 1/8" - 27 3/8"]	300 - 500 [11 1/8" - 19 1/8"]
350 [13 3/4"]	2.2 - 6.4 [1-2.9]	300 - 500 [11 1/8" - 19 1/8"]	300 - 400 [11 1/8" - 15 3/4"]
400 [15 3/4"]	1.8 - 5.5 [0.8-2.5]	300 - 350 [11 1/8" - 13 3/4"]	300 - 300 [11 1/8" - 11 1/8"]
450 [17 1/8"]	1.5 - 4.8 [0.7-2.2]	300 - 300 [11 1/8" - 11 1/8"]	N/A
500 [19 1/8"]	1.3 - 4.4 [0.6-2]	N/A	N/A

Heavy Applications - Black springs mounted on both sides

Door Height	Door Wt. lbs. [kg]	Door width small handle	Door width bar handle
250 [9 1/8"]	5.3 - 16.3 [2.4-7.4]	600 - 1200 [23 3/8" - 47 1/4"]	450 - 1200 [17 1/8" - 47 1/4"]
300 [11 1/8"]	4.4 - 13.9 [2-6.3]	450 - 1200 [17 1/8" - 47 1/4"]	300 - 1000 [11 1/8" - 39 3/4"]
350 [13 3/4"]	3.7 - 11.9 [1.7-5.4]	300 - 950 [11 1/8" - 37 3/8"]	300 - 750 [11 1/8" - 29 1/2"]
400 [15 3/4"]	3.3 - 10.3 [1.5-4.7]	300 - 700 [11 1/8" - 27 3/8"]	300 - 600 [11 1/8" - 24 1/8"]
450 [17 1/8"]	2.9 - 9.2 [1.3-4.2]	300 - 550 [11 1/8" - 21 3/8"]	300 - 450 [11 1/8" - 17 1/8"]
500 [19 1/8"]	2.9 - 8.6 [1.3-3.9]	300 - 450 [11 1/8" - 17 1/8"]	300 - 400 [11 1/8" - 15 3/4"]
550 [21 3/4"]	2.9 - 7.5 [1.3-3.4]	N/A	N/A
600 [23 3/4"]	2.9 - 6.8 [1.3-3.1]	N/A	N/A

Note: As there are adjustments for the spring balance and dampening force, rounding up or down to match your door height is possible.

For heavier doors than are shown in the tables, use the T-70 series.

- Weights based on 19mm [3/4"] thick MDF door with bar handle
- Bar handle weight is calculated at .22 lbs per 100mm [4"]
- A trial application is recommended in all situations



LID STAYS

Kinvaro Lifter System

The Kinvaro Lifter System opens a single door that pivots from the top of a wall cabinet. No Concealed hinges are required in the top panel.



Aluminum Frame

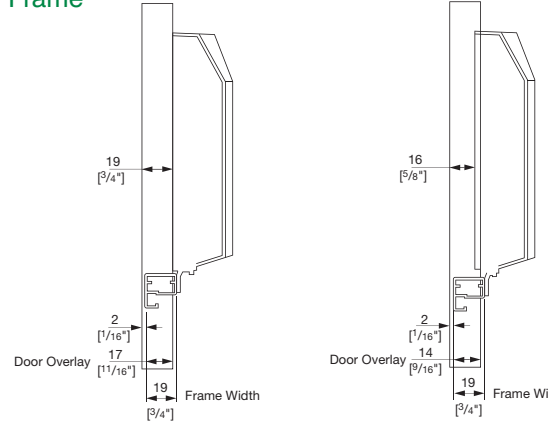

Door Type	Door Overlay	Order Number
Wood	14-9/16"	15-174

Panel Cabinet Applications

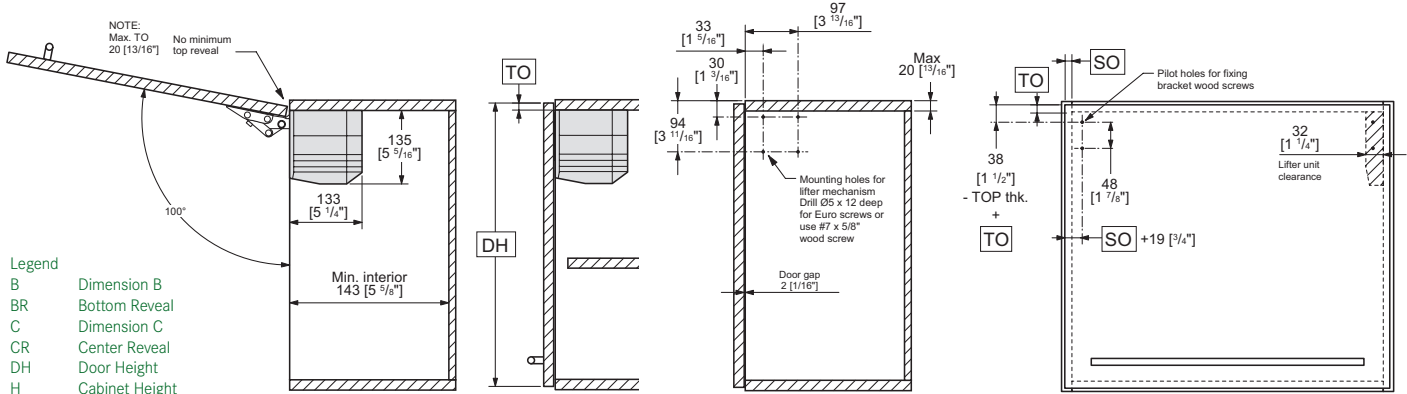

- Legend
- B Dimension B
 - BR Bottom Reveal
 - C Dimension C
 - CR Center Reveal
 - DH Door Height
 - H Cabinet Height
 - SO Side Overlay
 - TO Top Overlay
 - TR Top Reveal

$$DH = (H - TR - CR - BR) / 2$$

Face Frame Applications

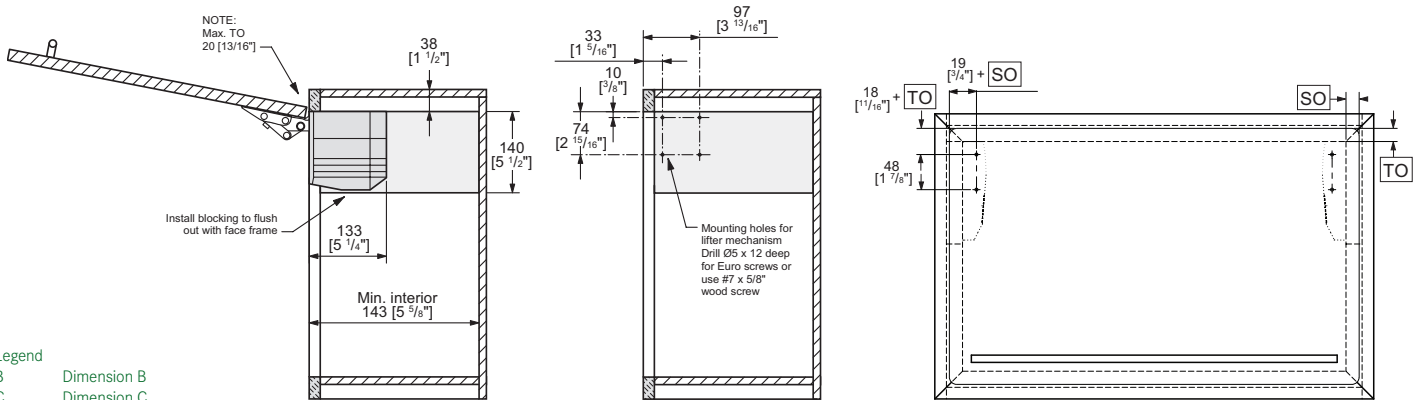

- Legend
- B Dimension B
 - C Dimension C
 - H Cabinet Height
 - SO Side Overlay
 - TO Top Overlay

Kitchens

Doors

Kitchen Accessories

Hinges

Drawer Slides

Plywood Melamine

Veneer Edgbanding

Laminate

Solid Surface

Closets

Furniture Hardware

Pulls & Knobs

Lighting

Grommets

Locks, Lock Systems

Molding, Carvings

Tools

Adhesives Solvents Abrasives

Chemicals Staples Screws



LID STAYS



Order number
15-150

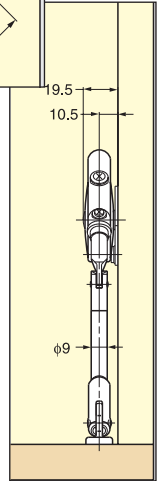
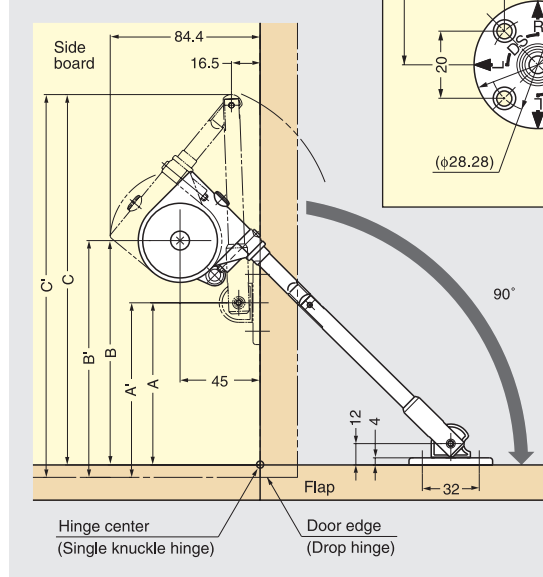
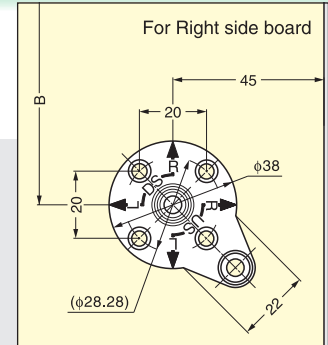

- Material: plastic, steel, Zinc alloy
- Finish: nickel
- Supplied with screws (3.5 x 14)
- Designed to securely latch a flap
- Available in white or black
- Recommended door thickness: 20 mm (25/32")
- Torque Calculation:
Torque = door height x 1/2 x door weight
Per piece: 35-50kg - cm (30-43 lbs. - inch)
Per pair: 70-100kg - cm (60-85 lbs. - inch)

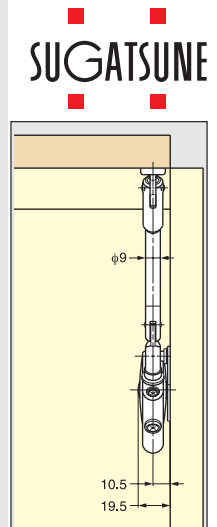
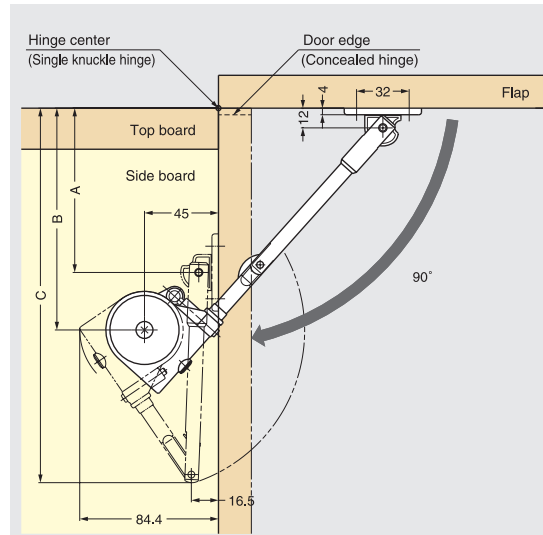

- Material: plastic, steel, Zinc alloy
- Finish: nickel
- Supplied with screws (3.5 x 14)
- Designed to securely latch a flap closed and hold the flap in the fully opened position
- Recommended door thickness: 20 mm (25/32")
- Torque Calculation:
Torque = door height x 1/2 x door weight
Per piece: 35-50kg - cm (30-43 lbs. - inch)
Per pair: 70-100kg - cm (60-85 lbs. - inch)
- Torque moment: 30-50kg cm/pc

Available in white or black
Light duty model also available
Order number 15-156

Econo Flap Stay

15" to 17" Flap Height Order number 15-102

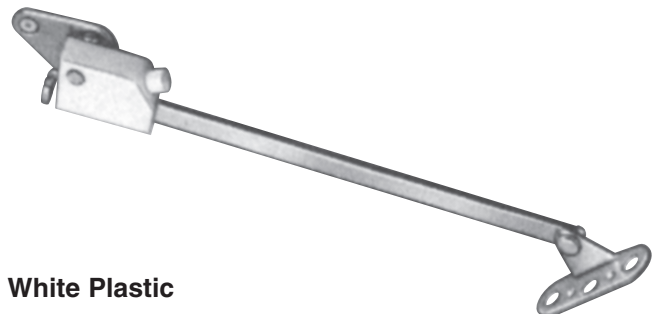

FINISH: Nickel and White Plastic

Kitchens

Doors

Kitchen Accessories

Hinges

Drawer Slides

Plywood Melamine

Veneer Edgebanding

Laminate

Solid Surface

Closets

Furniture Hardware

Pulls & Knobs

Lighting

Grommets

Locks, Lock Systems

Molding, Carvings

Tools

Adhesives Solvents Abrasives

Chemicals Staples Screws

LID STAYS

Lid Stays, Brackets & Pads

Kitchens

Doors

Kitchen Accessories

Hinges

Drawer Slides

Plywood Melamine

Veneer Edgebanding

Laminate

Solid Surface

Closets

Furniture Hardware

Pulls & Knobs

Lighting

Grommets

Locks, Lock Systems

Molding, Carvings

Tools

Adhesives Solvents Abrasives

Chemicals Staples Screws

European Lid Stay



ORDER NUMBER	DESCRIPTION	DOORS
15-112	80N GAS SPRING LID STAY	UP TO 17lbs.
15-114	100N GAS SPRING LID STAY	UP TO 23lbs.
15-116	120N GAS SPRING LID STAY	UP TO 27lbs.

Lid Stay

- All metal housing
- Black plastic stop and adjusting screw
- Attractive in appearance – box only 19/32" wide
- For lids up to 20 inches
- One piece normally sufficient
- Left and right interchangeable

Order number 15-122



Sold in pairs. Adjustable friction fitting allows lowering at slow speed. Finish is bright nickel and arm length is 10-1/4". Total length is 11". You may adjust degree of opening by changing mounting. Turn adjusting screw clockwise to reduce braking.

Folding Bracket

- Sold in pairs
- Locking device is in the supporting arm.
- Capacity: 50kg per pair
- Finish: white

Order number 15-124

To fold, lift slightly (to release the safety device). Press the release lever and the bracket will fold down.

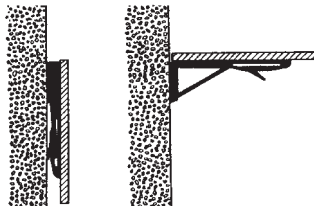

Adjustable Vertical Cabinet Door Lift

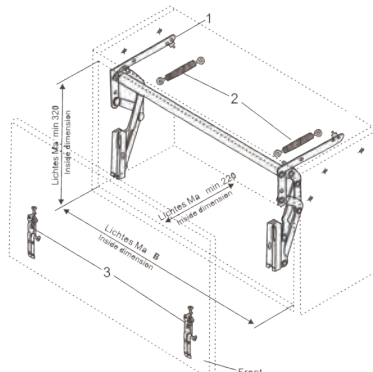

- Inside Width 600-900mm
- Max Front Weight 5kg
- Soft Opening Mechanism
- Ideal for European Style Cabinets
- Adjustable Frame for Perfect Fit

Order Number ...15-188